

# **OLYMPUS**

DIGITAL CAMERA

# Stylus 1050 SW / $\mu$ 1050 SW

## Instruction Manual

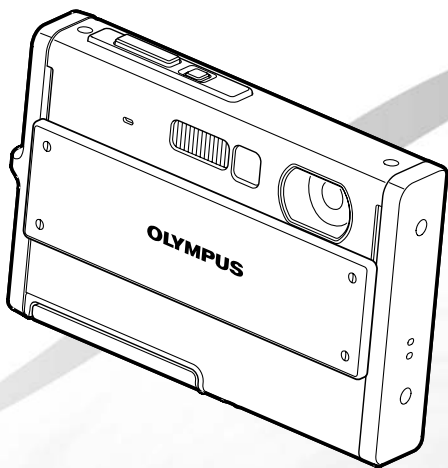

- Thank you for purchasing an Olympus digital camera. Before you start to use your new camera, please read these instructions carefully to enjoy optimum performance and a longer service life. Keep this manual in a safe place for future reference.
- We recommend that you take test shots to get accustomed to your camera before taking important photographs.
- In the interest of continually improving products, Olympus reserves the right to update or modify information contained in this manual.
- The screen and camera illustrations shown in this manual were produced during the development stages and may differ from the actual product.

## Step 1

### Preparing the Camera

"Preparing the Camera" (p. 10)

## Step 2

### Shooting and Playing Back Images

"Shooting, Playback, and Erasing" (p. 15)

## Step 3

### How to Use the Camera

"Four Types of Setting Operations" (p. 3)

## Step 4

### Printing

"Direct print (PictBridge)" (p. 50)

"Print order (DPOF)" (p. 53)

## Contents

➤ Names of Parts .....	6	➤ Menus for Playback, Editing, and Printing Functions.....	36
➤ Preparing the Camera .....	10	➤ Menus for Other Camera Settings .....	41
➤ Shooting, Playback, and Erasing.....	15	➤ Printing .....	50
➤ Using Shooting Modes.....	18	➤ Using OLYMPUS Master 2.....	56
➤ Using Shooting Functions.....	20	➤ Usage Tips .....	58
➤ Using Playback Features .....	25	➤ Appendix .....	63
➤ Menus for Shooting Functions.....	28	➤ Index .....	80



## Using the Direct Buttons

Frequently used shooting functions can be accessed using the direct buttons.

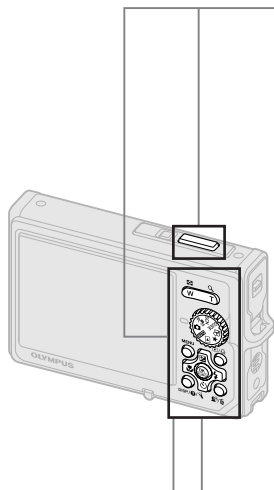

Shutter button (p. 15)



Zoom button (p. 20, p. 25)



☒ button (exposure compensation) (p. 21)

📷 button (macro) (p. 22)

⚡ button (flash) (p. 21)

🕒 button (self-timer) (p. 22)

▶ button (playback/print) (p. 16, p. 50)



DISP./📷 button (information display change/  
menu guide/date and time check/LED illuminator)  
(p. 3, p. 13, p. 23)

👤 button (Shadow Adjustment Technology/  
erase) (p. 17, p. 20)

## Using the FUNC Menu (p. 24)

Frequently used shooting menu functions can be set with less steps using the FUNC menu.

📷 button (p. 3, p. 24)

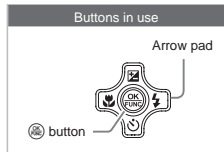

## Operating the camera by tapping the body (p. 48)

You can operate the camera by tapping the body when [TAP CONTROL] is [ON].

To set [TAP CONTROL] to [ON]

- 1 Tap the top surface of the camera twice.
  - The [TAP CONTROL] settings screen displays.
- 2 Tap the top surface of the camera twice.
  - The setting is confirmed.

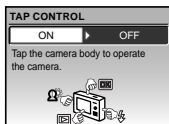
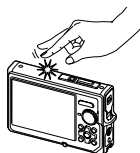

# Menu Index

## Menus for Shooting Functions

When the mode dial is set to a shooting mode position (AUTO ), settings can be made.

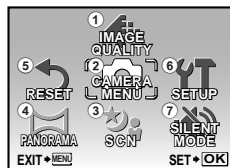

Shooting mode top menu

- |   |   |  |
|---|---|--|
| <ul style="list-style-type: none"> <li>①  IMAGE QUALITY ..... p.28</li> <li>②  CAMERA MENU           <ul style="list-style-type: none"> <li>WB..... p.29</li> <li>ISO ..... p.29</li> <li>DRIVE..... p.29</li> <li>FINE ZOOM..... p.30</li> <li>DIGITAL ZOOM ..... p.30</li> <li>ESP/..... p.30</li> <li>DIS MOVIE MODE<br/>(Only for  mode)... p.30</li> <li>AF MODE ..... p.31</li> <li> (Still picture REC) .... p.31</li> </ul> </li> </ul> | <ul style="list-style-type: none"> <li>③  SCN ..... p.31</li> <li>④  PANORAMA ..... p.33</li> <li>⑤  RESET ..... p.35</li> <li>⑥  SETUP           <ul style="list-style-type: none"> <li>MEMORY FORMAT/<br/>FORMAT ..... p.41</li> <li>BACKUP ..... p.41</li> <li> (Language) ..... p.41</li> <li>PW ON SETUP ..... p.42</li> <li>MENU COLOR ..... p.42</li> <li>SOUND SETTINGS..... p.43</li> <li>REC VIEW ..... p.43</li> </ul> </li> </ul> | <ul style="list-style-type: none"> <li>FILE NAME..... p.44</li> <li>PIXEL MAPPING ..... p.44</li> <li> (Monitor) ..... p.45</li> <li> (Date/time) ..... p.45</li> <li>DUALTIME..... p.45</li> <li>ALARM CLOCK..... p.46</li> <li>VIDEO OUT ..... p.46</li> <li>POWER SAVE..... p.47</li> <li>LED ILLUMINATOR..... p.47</li> <li>TAP CONTROL ..... p.48</li> <li>⑦  SILENT MODE ..... p.49</li> </ul> |
|---|---|--|

## Menus for Playback, Editing, and Printing Functions

When the mode dial is set to the position, settings can be made.

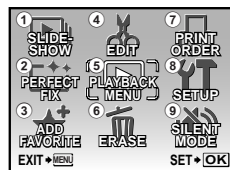

Playback mode top menu

- |  |   |  |
|--|---|--|
| <ul style="list-style-type: none"> <li>①  SLIDESHOW..... p.36</li> <li>②  PERFECT FIX ..... p.36</li> <li>③  ADD FAVORITE ..... p.36</li> <li>④  EDIT           <ul style="list-style-type: none"> <li> (Resize) ..... p.37</li> <li> (Crop) ..... p.37</li> <li>COLOR EDIT..... p.37</li> </ul> </li> </ul> | <ul style="list-style-type: none"> <li>CALENDAR..... p.38</li> <li>INDEX..... p.38</li> <li>⑤  PLAYBACK MENU           <ul style="list-style-type: none"> <li> (Protect) ..... p.38</li> <li> (Rotate)..... p.39</li> <li> (Post REC) ..... p.39</li> </ul> </li> <li>⑥  ERASE..... p.39</li> </ul> | <ul style="list-style-type: none"> <li>⑦  PRINT ORDER ..... p.40</li> <li>⑧  SETUP           <ul style="list-style-type: none"> <li>Same as "Menus for shooting functions"</li> </ul> </li> <li>⑨  SILENT MODE ..... p.49</li> </ul> |
|--|---|--|



# Names of Parts

## Camera unit

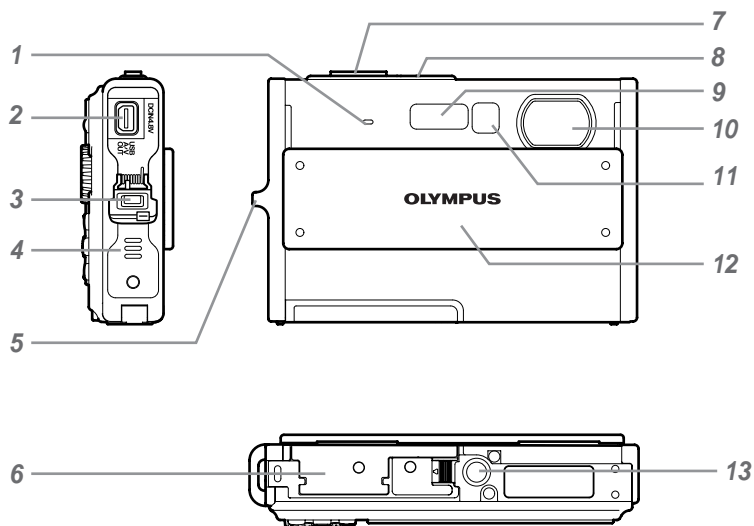

- |   |                  |   |                  |
|---|------------------|---|------------------|
| <b>1</b> Microphone .....                     | p.31, 39         | <b>8</b> <b>POWER</b> button .....              | p.13             |
| <b>2</b> Multi-connector .....                | p.47, 50, 56     | <b>9</b> Flash .....                            | p.21             |
| <b>3</b> Connector cover .....                | p.47, 50, 56, 68 | <b>10</b> Lens .....                            | p.63             |
| <b>4</b> Speaker .....                        | —                | <b>11</b> Self-timer lamp/LED illuminator ..... | p.22, 23, 32, 47 |
| <b>5</b> Strap eyelet.....                    | p.10             | <b>12</b> Lens barrier.....                     | p.15             |
| <b>6</b> Battery/card compartment cover ..... | p.11, 59, 68     | <b>13</b> Tripod socket .....                   | —                |
| <b>7</b> Shutter button .....                 | p.15, 58         |   |                  |

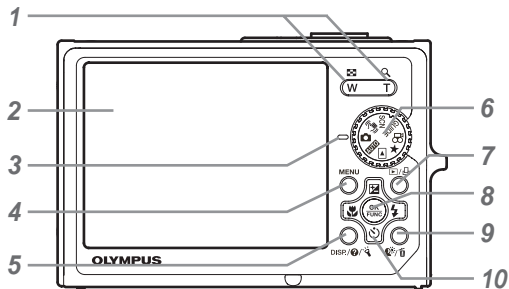

- |  |   |
|--|---|
| <p>1 Zoom button..... p.20, 25</p> <p>2 Monitor..... p.8, 15, 45, 59</p> <p>3 Card access lamp ..... p.65</p> <p>4 <b>MENU</b> button..... p.3, 5</p> <p>5 <b>DISP.</b>  button<br/>       (information display change/<br/>       menu guide/date and time check/<br/>       LED illuminator) ..... p.3, 13, 23</p> <p>6 Mode dial ..... p.3, 5, 13, 15, 16</p> <p>7  button (playback/print)<br/>       ..... p.16, 50</p> | <p>8  button ..... p.3, 24</p> <p>9  button<br/>       (Shadow Adjustment Technology/<br/>       erase)..... p.17, 20</p> <p>10 Arrow pad ..... p.3, 4, 12<br/>  button<br/>       (exposure compensation) ..... p.21<br/>  button (macro) ..... p.22<br/>  button (self-timer) ..... p.22<br/>  button (flash)..... p.21</p> |
|--|---|

Shooting mode display

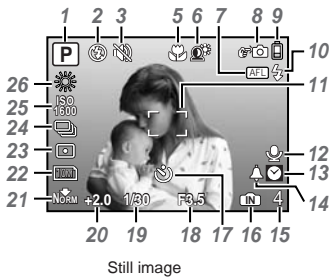

Still image

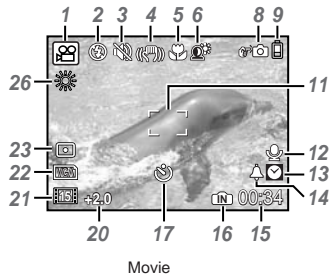

Movie

- 1 Shooting mode.....p.18, 19
- 2 Flash mode .....p.21
- 3 Silent mode.....p.49
- 4 Digital image stabilization .....p.30
- 5 Macro/super macro/  
S-macro LED mode .....p.22
- 6 Shadow Adjustment Technology...p.20
- 7 AF lock.....p.18
- 8 Tap control .....p.4, 32, 48
- 9 Battery check.....p.10, 59
- 10 Flash standby/  
camera shake warning/  
flash charge .....p.58
- 11 AF target mark.....p.15
- 12 Sound record .....p.19, 31
- 13 Dual time.....p.45

- 14 Alarm .....p.46
- 15 Number of storable still pictures/  
remaining recording time  
.....p.15, 19, 65
- 16 Current memory.....p.64
- 17 Self-timer .....p.22
- 18 Aperture value .....p.15
- 19 Shutter speed .....p.15
- 20 Exposure compensation .....p.21
- 21 Compression/Frame rate .....p.28
- 22 Image size .....p.28
- 23 Metering.....p.30
- 24 Drive .....p.29
- 25 ISO.....p.29
- 26 White balance .....p.29



## Playback mode display

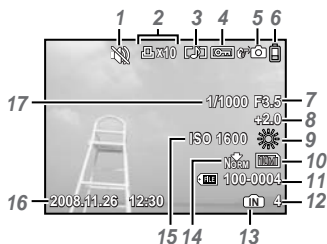

Still image

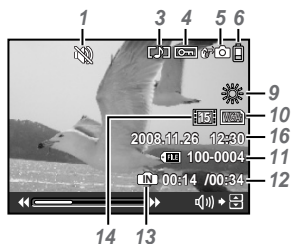

Movie

- |  |   |
|--|---|
| <p><b>1</b> Silent mode.....p.49</p> <p><b>2</b> Print reservation/<br/>number of prints..... p.53</p> <p><b>3</b> Sound record ..... p.19, 31, 39, 62</p> <p><b>4</b> Protect ..... p.38</p> <p><b>5</b> Tap control ..... p.4, 32, 48</p> <p><b>6</b> Battery check ..... p.10, 59</p> <p><b>7</b> Aperture value ..... p.15</p> <p><b>8</b> Exposure compensation ..... p.21</p> <p><b>9</b> White balance ..... p.29</p> | <p><b>10</b> Image size ..... p.28</p> <p><b>11</b> File number ..... p.44</p> <p><b>12</b> Frame number<br/>Elapsed time/<br/>total recording time ..... p.16, 17</p> <p><b>13</b> Current memory ..... p.64</p> <p><b>14</b> Compression/Frame rate ..... p.28</p> <p><b>15</b> ISO..... p.29</p> <p><b>16</b> Date and time ..... p.13, 45</p> <p><b>17</b> Shutter speed ..... p.15</p> |
|--|---|



# Preparing the Camera

## Checking the contents of the box



Digital camera



Strap

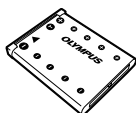

LI-42B Lithium Ion Battery



LI-40C Battery Charger



USB cable



AV cable



OLYMPUS Master 2  
CD-ROM



microSD Attachment

Other accessories not shown: Instruction Manual (this manual), warranty card  
Contents may vary depending on purchase location.

## Attaching the camera strap

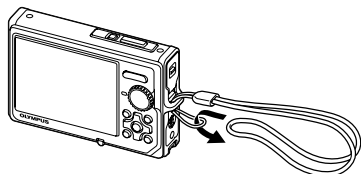

- ⚠ Pull the strap tight so that it does not come loose.

## Charging the battery

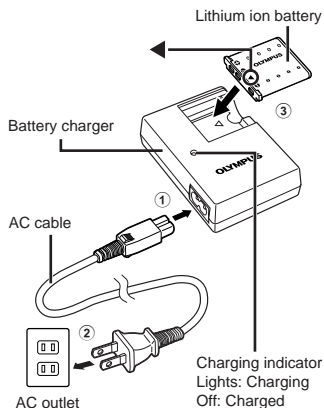

- ⚠ Battery comes partially charged. Before use, be sure to charge the battery until the charging indicator goes off (for approx. 5 hours).
- ⚠ For details on the battery and the charger, see "Battery and charger" (p. 63).

## When to charge the battery

Charge the battery when the error message shown below appears.

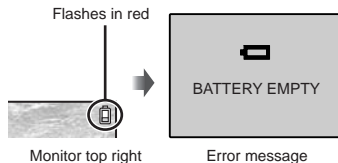

## Loading the battery and the xD-Picture Card™ (sold separately) into the camera

- Do not insert anything other than an xD-Picture Card or the microSD Attachment into the camera.

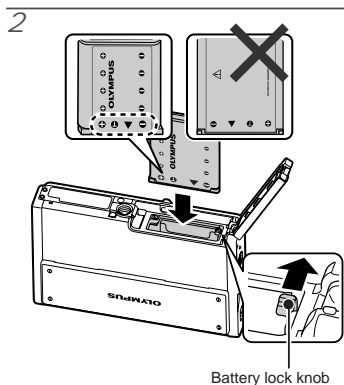
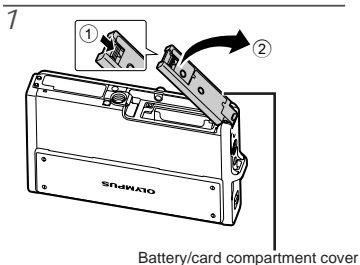

- Insert the battery by putting in the ▼ marked side first, with the ◐ marks toward the battery lock knob.
- Insert the battery while sliding the battery lock knob in the direction of the arrow.
- Sliding the battery lock knob in the direction of the arrow to unlock, and then remove the battery.

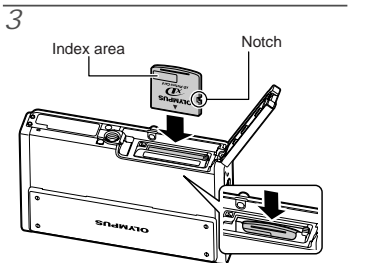

- Insert the card straight in until it clicks into place.
- Do not touch the contact area on the card.

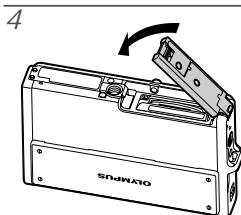

- This camera allows the user to take pictures using the internal memory even when no xD-Picture Card (sold separately) is inserted. "Using an xD-Picture Card" (p. 64)
- "Number of storable pictures (still pictures)/recording length (movies) in the internal memory and xD-Picture card" (p. 65)

## Removing the xD-Picture Card

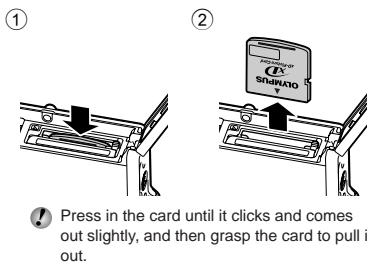

## Using a microSD card/ microSDHC card (sold separately)

microSD card/microSDHC card (hereinafter referred to as "the microSD card") is also compatible with this camera by using the microSD Attachment.

! "Using a microSD Attachment" (p. 66)

### 1 Insert the microSD card into the Attachment.

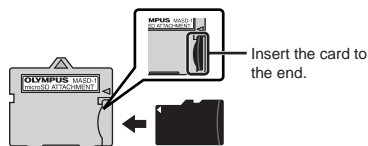

### 2 Insert the microSD Attachment into the camera.

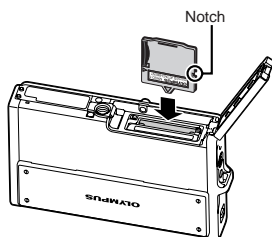

### To remove the microSD card

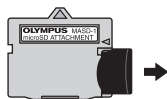

- ! Pull the microSD card straight out.
- ! Do not touch the contact area on the microSD Attachment and microSD card.

## Arrow pad and operation guide

The symbols  $\triangle$   $\nabla$   $\leftarrow$   $\rightarrow$ ,  $\left[ \right]$   $\left[ \right]$   $\left[ \right]$  displayed on various setting and movie playback screens indicate that arrow pad are used.

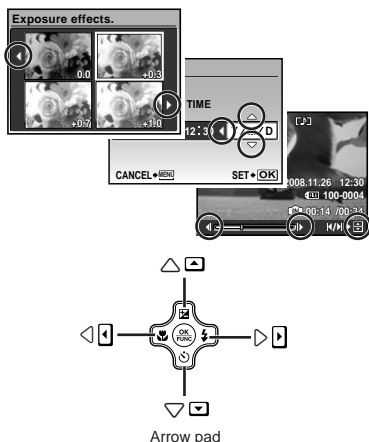

Operation guides displayed at the bottom of the screen indicate that the **MENU** button,  $\left[ \right]$  button, zoom button, or  $\left[ \right]$  button is used.

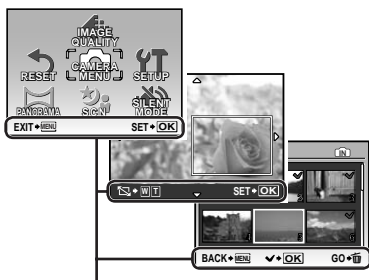

Operation guide

- ! When operating the camera in a dimly lit situation, hold down the  $\left[ \right]$  /  $\left[ \right]$  button in shooting mode to display the guide indicating the location of the buttons.

## Setting the date and time

The date and time set here are saved to image file names, date prints, and other data.

### 1 Press the **POWER** button to turn on the camera.

- The date and time setting screen is displayed when the date and time are not set.

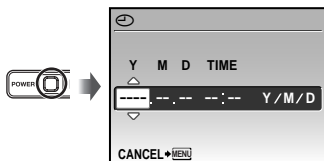

Date and time setting screen

### 2 Use **▲** **▶** **▼** to select the year for [Y].

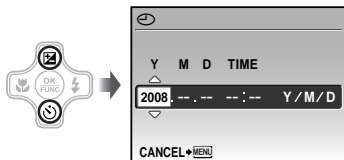

### 3 Press the **OK/FUNC** button to save the setting for [Y].

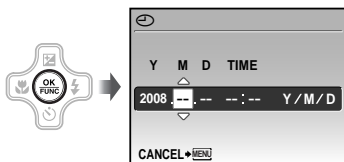

### 4 As in steps 2 and 3, use **▲** **▶** **▼** and the **OK/FUNC** button to set [M] (month), [D] (day), and [TIME] (hours and minutes).

- ! For precise time setting, press the **OK/FUNC** button as the time signal strikes 00 seconds.
- ! To change the date and time, make the setting from the menu. [**☰**] (**Date/time**) (p. 45)

#### To check the date and time

Press the **DISP.** button while the camera is turned off. The current time and alarm time are displayed for approx. 3 seconds.

## Changing the display language

The language for the menu and error messages displayed on the monitor is selectable.

### 1 Set the mode dial to a position other than **GUIDE**, ★.



### 2 Press the **MENU** button, and press **▲** **▶** **▼** to select [**↑** **SETUP**].

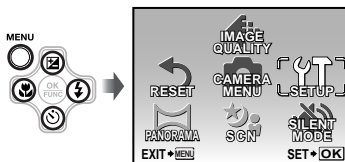

3 Press the  button.

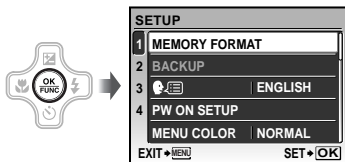

4 Use   to select [] and press the  button.



5 Use     to select your language and press the  button.

6 Press the MENU button.



# Shooting, Playback, and Erasing

## Shooting with automatic settings (**AUTO** mode)

This is a fully automatic mode that allows the user to take pictures by simply pressing the shutter button without using the menu to make detailed settings.

- ⚠ All shooting settings return to the default settings when the camera is turned off. In **☑** mode, all shooting settings are saved even when the power is turned off.

### 1 Set the mode dial to **AUTO**.



### 2 Slide the lens barrier down to turn on the camera.

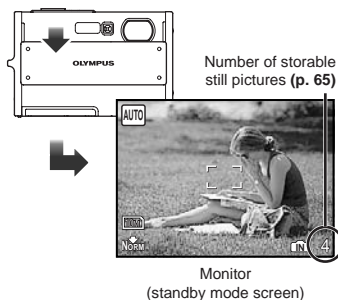

### 3 Hold the camera, and compose the shot.

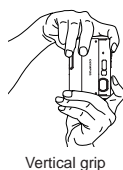
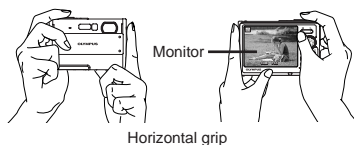

### 4 Press the shutter button halfway down to focus on the subject.

- When the camera focuses on the subject, the exposure is locked (shutter speed and aperture value are displayed), and the AF target mark changes to green.
- The camera was unable to focus if the AF target mark flashes red. Try focusing again.

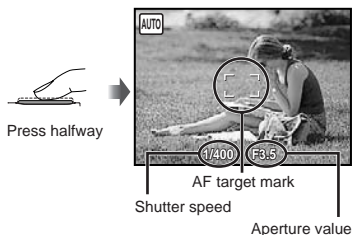

- ⚠ "Focusing" (p. 60)

- 5 To take the picture, gently press the shutter button all the way down while being careful not to shake the camera.

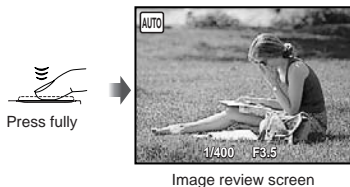

### To view images during shooting

Pressing the button enables playback of images. To return to shooting, either press the button again or press the shutter button halfway down.

- ! You can operate the camera by tapping the body when [TAP CONTROL] is [ON].  
[TAP CONTROL] (p. 48)

### To shoot movies

“Shooting movies ( mode)” (p. 19)

### When shooting is finished

Slide the lens barrier up to turn off the camera.

- You can also press the **POWER** button to turn the camera off.

## Viewing images

- 1 Set the mode dial to .

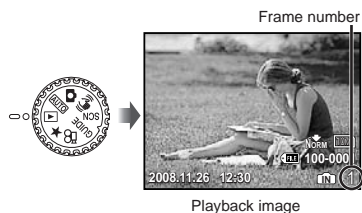

- 2 Use to select an image.

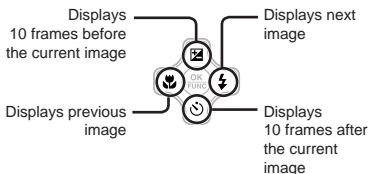

- ! The display size of the images can be changed. “Index view, calendar view, and closeup view” (p. 25)



## To play back movies

Select a movie, and press the **PLAY** button.



Movie

## Operations during movie playback

Volume: During playback, press **UP** or **DOWN**.

Fast-forward/rewind: Select with **FF** or **REW**.

Each time a button is pressed, the playback speed cycles through 2x, 20x, and standard (1x) speed in the direction of the pressed button.

Pause: Press the **STOP** button.



Elapsed time/  
Total recording time

During playback

First (last) frame/frame advance:

During pause, press **FF** to display the first frame, and press **REW** to display the last frame. Playback is reversed while **REW** is pressed, playback occurs normally while **FF** is pressed. Press the **STOP** button to resume playback.



During pause

## To stop movie playback

Press the **MENU** button.

## Erasing images during playback (Single image erase)

- 1 Press the **ERASE** button when the playback image to be erased is displayed.



- 2 Press **UP** to select [YES], and press the **STOP** button.

**!** [ERASE] (p. 39)



# Using Shooting Modes

This section describes the available shooting modes. Depending on the mode, some settings can be changed. For details on the functions that can be adjusted, see “Menus for Shooting Functions” on page 28.

## Using the best mode for the shooting scene (**SCN** mode)

### 1 Set the mode dial to **SCN**.



- An explanation of the selected mode is displayed while the button is pressed and held.

### 2 Use to select the best shooting mode for the scene, and press the button.

Icon indicating the scene mode that is set



- ! To change to another scene mode, use the menu. [] **SCN**] (p. 31)

### To take underwater photos

Select [] **UNDERWATER SNAPSHOT**].

- ! “Important information about water and shock resistant features” (p. 66)

### To lock the focus distance for an underwater shot (**AF lock**)

When [] **UNDERWATER SNAPSHOT**] is selected, press .

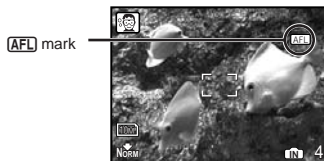

- ! To cancel, press again to clear the **AF-L** mark.

## Shooting with optimum aperture value and shutter speed (**P** mode)

In this mode, automatic camera shooting can be used while also allowing changes to a wide range of other shooting menu functions, such as exposure compensation, white balance, and so on when needed.

### 1 Set the mode dial to .

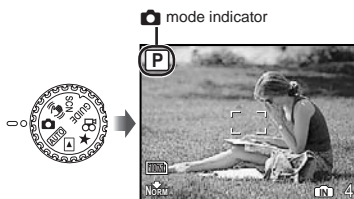

## Using the digital image stabilization mode (()) mode)

This mode enables the user to reduce blurring that is caused by a camera shake and subject movement.

### 1 Set the mode dial to (()).

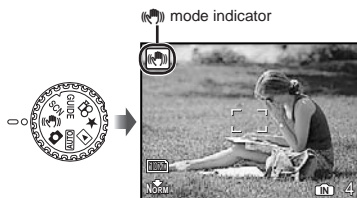

## Shooting movies ( mode)

Audio is recorded with the movie.

### 1 Set the mode dial to .

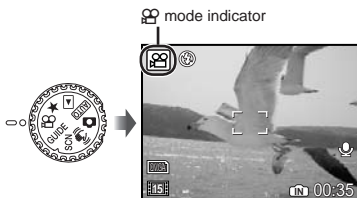

#### To zoom while shooting a movie

The optical zoom is not available while shooting a movie.

Use [DIGITAL ZOOM] (p. 30).

#### To shoot a movie with digital image stabilization

[DIS MOVIE MODE] (p. 30)

### 2 Press the shutter button halfway down to focus on the subject, and gently press the button all the way down to start recording.

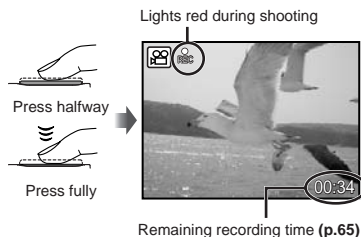

### 3 Gently press the shutter button all the way down to stop recording.



# Using Shooting Functions

In addition to the wide variety of shooting modes, the camera has functions that broaden the expressive range and shooting options available to the photographer.

## Using the optical zoom

Pressing the zoom button adjusts the shooting range.

Pressing the wide (W) button      Pressing the telephoto (T) button

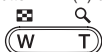

Zoom bar

- Optical zoom: 3.0 x, Digital zoom: 5.0 x.
- Use of **AF-ON** mode (p. 19) is recommended when shooting with the telephoto zoom.

**To take larger images without reducing image quality**

[FINE ZOOM] (p. 30)

**To take larger images**

[DIGITAL ZOOM] (p. 30)

- The zoom bar appearance identifies the status of the fine zoom/digital zoom.

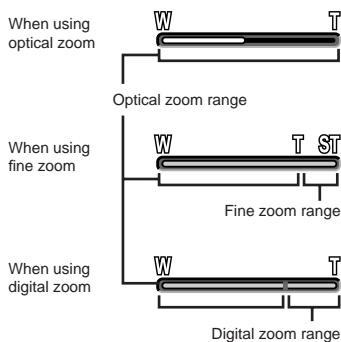

## Brightening the subject against backlight (SHADOW ADJ<sup>\*1</sup>)

The camera finds a person's face that has been darkened by backlight and makes it appear brighter for taking the picture.

<sup>\*1</sup> Shadow adjustment technology

### 1 Press the **Q** button.

- You can operate the camera by tapping the body when [TAP CONTROL] is [ON]. [TAP CONTROL] (p. 48)

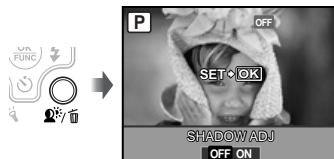

- 2 Use to select [ON], and press the button to set.

- 3 Point the camera toward the subject. Check the frame appearing around the face detected by the camera, and then press the shutter button to take the picture.

- ⓘ For some subjects, the frame may not appear or may take some time to appear.
- ⓘ When set to [ON], [ESP/] (p. 30) is automatically fixed to [ESP], and [AF MODE] (p. 31) is automatically fixed to [FACE DETECT].

### Using the flash

The flash functions can be selected to best match the shooting conditions and render the desired image.

- 1 Press the button.

- ⓘ You can operate the camera by tapping the body when [TAP CONTROL] is [ON]. [TAP CONTROL] (p. 48)



- 2 Use to select the setting option, and press the button to set.

Item	Description
FLASH AUTO	The flash fires automatically in low-light or backlight conditions.
REDEYE	This emits pre-flashes to reduce the occurrence of red eye in your photos.
FILL IN	The flash fires regardless of the available light.
FLASH OFF	The flash does not fire.

### Adjusting the brightness (Exposure compensation)

The standard brightness (appropriate exposure) can be adjusted brighter or darker to obtain the desired shot.

- 1 Press the button.

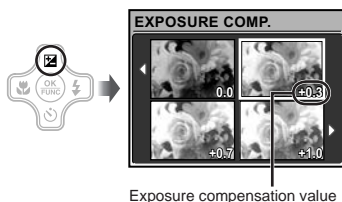

- 2 Use to select the desired brightness image, and press the button.

## Shooting closeups (Macro shooting)

This function enables the camera to focus and shoot subjects at close distances.

### 1 Press the button.

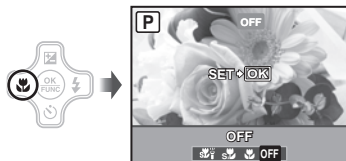

### 2 Use to select the setting option, and press the button to set.



Item	Description
OFF	Macro mode is deactivated.
MACRO	This enables shooting as close as 20 cm/7.9 in. <sup>1)</sup> (30 cm/11.8 in. <sup>2)</sup> to the subject.
SUPER MACRO <sup>3)</sup>	This enables shooting as close as 7 cm/2.8 in. to the subject. Subjects at 50 cm/19.7 in. or farther cannot be brought into focus.
S-MACRO LED <sup>3)4)</sup>	The LED illuminator lights the area 7 to 20 cm (2.8 to 7.9 in.) from the lens, while the shutter button is pressed halfway down.

<sup>1)</sup> When the zoom is at the widest (W) position.

<sup>2)</sup> When the zoom is at the most telephoto (T) position.

<sup>3)</sup> The zoom is automatically fixed.

<sup>4)</sup> [ISO] (p. 29) is automatically fixed to [AUTO].

 The **flash** (p. 21) and **zoom** (p. 20) cannot be set when  or  is selected.

## Using the self-timer

After the shutter button is pressed all the way down, the picture is taken after a time delay.

### 1 Press the button.

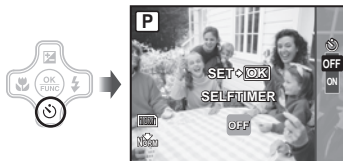

### 2 Use to select the setting option, and press the button to set.

Item	Description
OFF	This cancels the self-timer.
ON	The self-timer lamp turns on for approx. 10 seconds, and then blinks for approx. 2 seconds, and then the picture is taken.

 Self-timer shooting is automatically canceled after one shot.

**To cancel the self-timer after it starts**  
Press the  button again.

## Using the LED illuminator

In a dark location, the LED illuminator can be used as an auxiliary light to see things or compose shots.

### 1 Set [LED ILLUMINATOR] (p. 47) to [ON].

### 2 Press and hold the button down until the LED illuminator lights up.

- If you perform an operation when the LED illuminator is on, it will illuminate up to approx. 90 seconds.

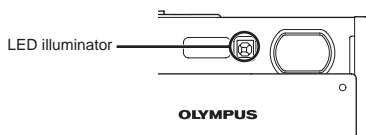

- The LED illuminator turns off if no operation is performed for approx. 30 seconds.

- Even when the camera's power is turned off, if the lens barrier is opened, the LED illuminator lights for 30 seconds.

### To turn the LED illuminator off

Press and hold the  button down, until the LED illuminator turns off.

## Changing the shooting information display

The display of the screen information can be changed to best match the situation, such as for the need of clear view of the screen or for making a precise composition by using the grid display.

### 1 Press the DISP. button.

- The displayed shooting information changes in the order shown below each time the button is pressed. "Shooting mode display" (p. 8)

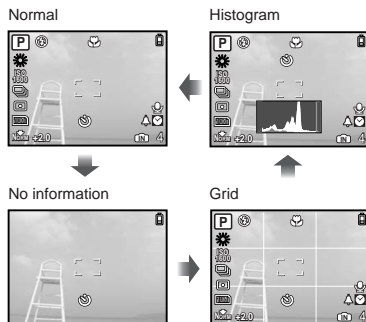

### Reading a histogram

If the peak fills too much of the frame, the image will appear mostly white.

If the peak fills too much of the frame, the image will appear mostly black.

The green section shows the luminance distribution in the center area of the monitor.



## Using the FUNC menu

The FUNC menu provides the following menu functions that can be quickly called and set.

- [WB] (p. 29)
- [ESP/□] (p. 30)
- [ISO] (p. 29)
- [⇐: IMAGE QUALITY] (p. 28)
- [DRIVE] (p. 29)

### 1 Press the button.

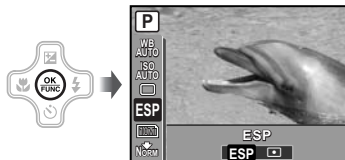

### 2 Use to select the menu function and to select the setting option, and then press the button to set.

## Making settings by following the shooting guide (GUIDE mode)

This provides an on-screen guide for the user to automatically make a desired camera setting such as adjusting the setting for a subject or selecting the shooting setting to obtain a desired effect.

### 1 Set the mode dial to GUIDE.

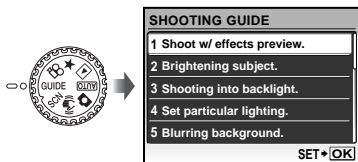





### 2 Follow the guide by using , , and to proceed.

- Pressing the  button completes the setting and makes the camera ready for shooting.



- ! To make another setting, press the **MENU** button. Functions set using the shooting guide will revert to the default settings.
- ! To shoot in a different shooting mode, change the mode dial. Functions set using the shooting guide will revert to the default settings.

## To use the effects preview screen

Selecting an option under [1 Shoot w/ effects preview.] shows 4 preview images that reflect the adjusted values of the selected shooting function. Use , , and  to select the desired image, and press the  button.





# Using Playback Features

## Index view, calendar view, and closeup view

Index view and calendar view enable quick selection of a target image. Closeup view (up to 10x magnification) allows checking of image details.

### 1 Press the zoom button.



### To select an image in index view

Use to select an image, and press the button to display the selected image in single-image view.

### To select images in calendar view

Use to select a date and press the button or T on the zoom button to view the images taken on the selected date.

### To scroll an image in closeup view

Use to move the viewing area.

## Changing the image information display

A set of shooting information displayed on the screen can be changed.

### 1 Press the DISP. button.

- The displayed image information changes in the order shown below each time the button is pressed.

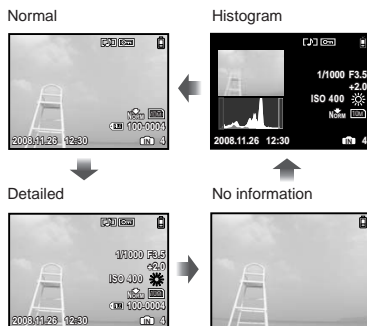

! "Reading a histogram" (p. 23)

## Playing back panorama images

Panorama images that were combined together using [COMBINE IN CAMERA 1] or [COMBINE IN CAMERA 2] can be scrolled for viewing.

- ! "Creating panoramic images [PANORAMA]" (p. 33)

### 1 Select a panorama image during playback.

- ! "Viewing images" (p. 16)

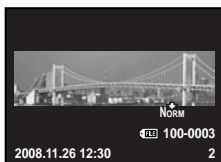





### 2 Press the button.



Current viewing area

### To control panorama image playback

**Zoom in/Zoom out:** Press the zoom button.

**Playback direction:** Press     to scroll in the direction of the pressed button.

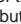
**Pause:** Press the  button.

**Restart scrolling:** Press the  button.

**Stop playback:** Press the **MENU** button.

## Playing back My Favorite images

The user's favorite images (max. of 9 images) can be registered in the internal memory.

- ! Registered pictures cannot be erased even by formatting the internal memory.

### 1 Register images as My Favorite images.

- ! "Registering images to the internal memory as My Favorite images [★ ADD FAVORITE]" (p. 36)

### 2 Set the mode dial to .



### 3 Use to select My Favorite image.

## To play back My Favorite images automatically (Slideshow)

- 1 Press the **MENU** button while playing back My Favorite images.

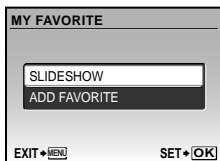

- 2 Use to select [SLIDESHOW], and then press the button.

## To register additional My Favorite images



- 1 Press the **MENU** button while playing back My Favorite images.
- 2 Use to select [ADD FAVORITE], and then press the button.
- 3 Use to select an image to register, and press the button.

## To remove registered My Favorite images

- 1 Use to select the My Favorite image to erase and press the button.
  - 2 Use to select [YES], and then press the button.
- Removing a picture from My Favorite does not erase the original picture recorded in the internal memory or to the card.

# Menus for Shooting Functions

When the mode dial is set to a shooting mode position (**AUTO**   **SCN** ) , settings can be made.

-  indicates positions of the mode dial at which the function can be set.
-  The default settings of the function are highlighted in  .

## Selecting the appropriate image quality for your application [ **IMAGE QUALITY**]

 **IMAGE QUALITY**

 : **AUTO**   **SCN** 

### Still images

Submenu 1	Submenu 2	Application
IMAGE SIZE	<b>10M (3648×2736)</b>	Suitable for printing pictures over A3 (11×17 in.).
	5M (2560×1920)	Suitable for printing pictures at A4 (8.5×11 in.).
	3M (2048×1536)	Suitable for printing pictures up to A4 (8.5×11 in.).
	2M (1600×1200)	Suitable for printing pictures at A5 (5×7 in.).
	1M (1280×960)	Suitable for printing pictures at postcard size.
	VGA (640×480)	Suitable for viewing pictures on a TV or using pictures on emails and web sites.
	16:9 (1920×1080)	Suitable for playing pictures on wide screen TV.
COMPRESSION	FINE	Shooting at high quality.
	<b>NORMAL</b>	Shooting at normal quality.

### Movies

Submenu 1	Submenu 2	Application
IMAGE SIZE	VGA (640×480) / QVGA (320×240)	Select the image quality based on the image size and frame rate. Higher frame rates provide smoother video images.
FRAME RATE	<b>30</b> 30fps <sup>*1</sup> / 15 15fps <sup>*1</sup>	

<sup>\*1</sup> frames per second



## Adjusting to a natural color scheme [WB]

CAMERA MENU ► WB



Submenu 2	Application
AUTO	The camera automatically adjusts the white balance according to the shooting scene.
	For shooting outdoors under a clear sky
	For shooting outdoors under a cloudy sky
	For shooting under tungsten lighting
	For shooting under daylight fluorescent lighting (household lighting, etc.)
	For shooting under neutral fluorescent lighting (desk lamps, etc.)
	For shooting under white fluorescent lighting (offices, etc.)

## Selecting the ISO sensitivity [ISO]

CAMERA MENU ► ISO



- In the ISO setting, although smaller values result in less sensitivity, sharp images can be taken under fully lit conditions. Larger values result in higher sensitivity, and images can be taken at fast shutter speeds even under dimly lit conditions. High sensitivity introduces electrostatic noise into the resulting picture, which may give it a grainy appearance.

Submenu 2	Application
AUTO	The camera automatically adjusts the sensitivity according to the shooting scene.
80/100/200/400/800/1600	The ISO (sensitivity) setting is fixed by manually selecting it.

## Shooting pictures sequentially while the shutter button is held down [DRIVE]

CAMERA MENU ► DRIVE



Submenu 2	Application
	One frame is shot each time the shutter button is pressed.
<sup>*1</sup>	Sequential shooting at the focus, brightness (exposure), and white balance that is locked in the first frame.
	Sequential shooting at a higher speed than .

\*1 The shooting speed varies depending on the settings for [IMAGE QUALITY] (p. 28).

- "Saving only selected images from sequentially shot images ([SHOOT & SELECT 1]/[SHOOT & SELECT 2] mode)" (p. 32)
- When set to , (Still picture REC) (P. 31) is not available.
- When set to , flash is set fixed (FLASH OFF) and [ISO] is fixed to [AUTO].
- When set to , [IMAGE SIZE] is limited to or lower. Moreover, [FINE ZOOM] (p. 30), [DIGITAL ZOOM] (p. 30), and (Still picture REC) (p. 31) are not available.

### Shooting at higher magnifications than optical zoom without reducing the image quality [FINE ZOOM]

CAMERA MENU ► FINE ZOOM

:

Submenu 2	Application
OFF	Only optical zoom is used to zoom in for shooting.
ON	Optical zoom and image cropping are combined to zoom in for shooting (up to 17×).

- This function will not reduce the image quality since it does not convert the data with fewer pixels into the data with larger pixels.
- When set to [ON], [IMAGE SIZE] is limited to [5M] or lower.
- This function is not available when [DIGITAL ZOOM] is [ON].
- This function is not available when [S-MACRO SUPER MACRO] (p. 22) or [S-MACRO LED] (p. 22) is selected.

### Shooting at higher magnifications than optical zoom [DIGITAL ZOOM]

CAMERA MENU ► DIGITAL ZOOM

:

Submenu 2	Application
OFF	Only optical zoom is used to zoom in for shooting.
ON	Optical zoom and digital zoom are combined to zoom in for shooting (Approx. 15x (max.)).

- This function is not available when [FINE ZOOM] is [ON].
- This function is not available when [S-MACRO SUPER MACRO] (p. 22) or [S-MACRO LED] (p. 22) is selected.

### Selecting the range for measuring the brightness [ESP/SPOT]

CAMERA MENU ► ESP/SPOT

:

Submenu 2	Application
ESP	Shoots to obtain a balanced brightness over the entire screen. (Meters the brightness at the center and surrounding areas of the screen separately.)
(spot)	Shoots the subject at the center during backlighting.

- When set to [ESP], the center may appear dark when shooting against strong backlighting.

### Shooting in digital image stabilization movie mode [DIS MOVIE MODE]

CAMERA MENU ► DIS MOVIE MODE

:

Submenu 2	Application
OFF	Cancels digital image stabilization mode.
ON	Shooting movies with digital image stabilization. Images will appear slightly magnified.

- Images may not be correctable if the camera is severely shaken or the subject's motion is excessive.
- Select [OFF] when recording movie with the camera physically stabilized. If not, the movie you are capturing may shake along with the subject.



## Selecting the focusing area [AF MODE]

CAMERA MENU ► AF MODE

: SCN

Submenu 2	Application
FACE DETECT <sup>1)</sup>	This is used for taking pictures of people. (The camera automatically detects a face and displays a frame on the monitor). Press the shutter button halfway, when the camera focuses on a face the AF target mark lights green. When the AF target mark lights orange, this indicates the camera has focused on something other than a face.
iESP	This enables you to compose the shot without worrying about the focusing position. The camera finds the subject to focus on and automatically adjusts the focus.
SPOT	The camera focuses on the subject within the AF target mark.

<sup>1)</sup> For some subjects, the frame may not appear or may take some time to appear.

## Recording sound when shooting still images [🎤]

CAMERA MENU ►

: SCN

Submenu 2	Application
OFF	No sound is recorded.
ON	The camera automatically starts recording for approx. 4 seconds after taking the picture. This is useful for recording notes or comments about the picture.

When recording, aim the microphone (p. 6) at the source of the sound you want to record.

## Selecting a scene mode according to the shooting situation [👤 SCN]

: SCN

: SCN

In **SCN** mode, the optimum shooting settings are pre-programmed for specific shooting scenes. For this reason, settings may not be changed in some modes.

Submenu 1	Application
PORTRAIT/ LANDSCAPE/ LANDSCAPE+PORTRAIT/ NIGHT SCENE <sup>1)</sup> / NIGHT+PORTRAIT <sup>1)</sup> / SPORT/ INDOOR/ CANDLE <sup>1)</sup> / SELF PORTRAIT/ AVAILABLE LIGHT <sup>1)</sup> / SUNSET <sup>1)</sup> / FIREWORKS <sup>1)</sup> / [CUISINE/ BEHIND GLASS/ DOCUMENTS/ AUCTION <sup>2)</sup> / SHOOT & SELECT 1 <sup>2)</sup> / SHOOT & SELECT 2 <sup>2)</sup> / SMILE SHOT <sup>2)</sup> / BEACH & SNOW/ PRE-CAPTURE MOVIE/ UNDERWATER SNAPSHOT/ SNOW	The camera takes a picture in the mode for the shooting scene.

<sup>1)</sup> When the subject is dark, noise reduction is automatically activated. This approximately doubles the shooting time, during which no other pictures can be taken.

<sup>2)</sup> The focus is locked at the first frame.

<sup>3)</sup> The camera focuses for each frame.

**To shoot with the selected mode "Using the best mode for the shooting scene (SCN mode)" (p. 18)**

### Saving only selected images from sequentially shot images ([SHOOT & SELECT 1]/[SHOOT & SELECT 2] mode)

- 1 Select [SHOOT & SELECT 1] or [SHOOT & SELECT 2]. Hold down the shutter button to take sequential shots.

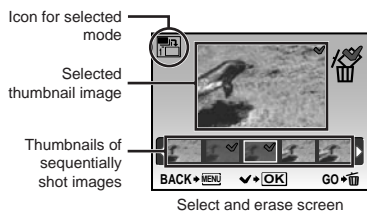

- 2 Use the [ ] to select the image to be erased, and then press the [ ] button.

✓ mark is added to the thumbnail.



- 3 Repeat Step 2 to select the images to be erased, and then press the [ ] button to erase the selected images.

### Detecting a smiling face to release the shutter automatically ([SMILE SHOT] mode)

- 1 Select [SMILE SHOT], and then aim the camera towards the subject.
  - The self-timer lamp turns on. When a smiling face is detected, the camera automatically takes 3 sequential shots.
- ! Pictures can also be taken manually by pressing the shutter button.
- ! The camera may not be able to detect a smiling face for some subjects.

### Capturing the perfect moment when shooting ([PRE-CAPTURE MOVIE] mode)

- 1 Use [ ] to select [PRE-CAPTURE MOVIE], and then press the [ ] button to set.
  - This function is ready for shooting immediately after setting this option.
- 2 Press the shutter button to start movie shooting.
  - A 7-second movie, including 2-second movie immediately before pressing the shutter button, is taken.
  - The optical zoom and auto focus function are available during movie recording.
- ! Sound is not recorded.
- ! AF target mark does not appear on the monitor.
- ! Select [IMAGE SIZE] from [VGA] or [QVGA], and select [FRAME RATE] from [30] 30fps or [15] 15fps.

### Tapping the camera to shoot a picture ([SNOW] mode)

- 1 Select [SNOW], and then press the [ ] button.
  - [TAP CONTROL] (p. 48) automatically becomes active and the camera can be operated by tapping.
- 2 Tap the back of the camera body twice.
  - [SELFTIMER] becomes active and the picture is automatically taken after 2 seconds.





## Creating panoramic images

### [PANORAMA]

#### ☰ PANORAMA



- ❗ An Olympus xD-Picture Card is required for panoramic shooting. Cards by other manufacturers do not support panoramic shooting.
- ❗ Panoramic shooting is not available using the microSD card in a microSD Attachment.

Submenu 1	Application
COMBINE IN CAMERA 1 <sup>1,2</sup>	Three frames are taken and combined by the camera. The user only composes the shots so that the target marks and pointers overlap, and the camera automatically releases the shutter. The shooting functions are already preset to the optimum settings for panoramic shooting.
COMBINE IN CAMERA 2 <sup>1,2</sup>	Three frames are taken and combined by the camera. The user composes the shots using the guide frame and manually releases the shutter.
COMBINE IN PC	The frames that were taken are combined into a panorama image using the OLYMPUS Master software from the provided CD-ROM. Pictures are taken in the last [ISO] or [SCN] settings (except for some scene modes).

<sup>1</sup> Not available in [P] mode (p. 19), [SCN] mode (p. 18).

<sup>2</sup> The [IMAGE QUALITY] (p. 28) setting cannot be changed.

- ❗ The focus, exposure (p. 21), zoom position (p. 20), and [WB] (p. 29) are locked at the first frame.
- ❗ The flash (p. 21) is fixed to [OFF] (FLASH OFF) mode.
- ❗ Panorama images can be edited using [LIGHTING FIX] (p. 36), [COLOR EDIT] (p. 37) only.
- ❗ "Playing back panorama images" (p. 26)

## Taking pictures with

### [COMBINE IN CAMERA 1]

- ① Press the shutter button to take the first frame.
- ② Move the camera slightly in the direction of the second frame.



Screen when combining images from left to right

- ③ Move the camera slowly while keeping it straight, and stop the camera where the pointer and target mark overlap.
  - The camera releases the shutter automatically.



- ❗ To combine only two pictures, press the [2] button before taking the third frame.
- ④ Take the third frame in the same way as Step ③.

- After the third frame is taken, the camera automatically processes the frames and the combined panorama image is displayed.
- ❗ To cancel making panoramic picture during shooting, press the [MENU] button.
- ❗ When the shutter does not automatically release, try [COMBINE IN CAMERA 2] or [COMBINE IN PC].

## Taking pictures with [COMBINE IN CAMERA 2]

- Use to select the direction that the frames are combined.



- Press the shutter button to take the first frame.

- A guide frame appears as a reference.

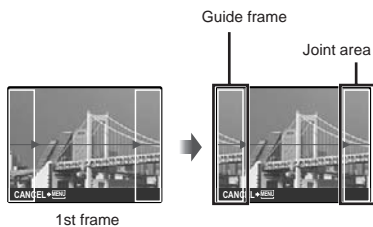

- Compose the second shot so that the joint area overlaps the guide frame.



- Press the shutter button to take the second frame.
- To combine only two pictures, press the button before taking the third frame.
- Take the third frame in the same way as Steps ③ to ④.
  - After the third frame is taken, the camera automatically processes the frames and the combined panorama image is displayed.
- To cancel making panoramic picture during shooting, press the **MENU** button.

## Taking pictures with [COMBINE IN PC]

- Use to select the direction that the frames are combined.
- Press the shutter button to take the first frame, and then compose the second shot.
  - Compose the shot using the guide frame so that the two adjacent frames overlap.
- Repeat Step ② until the number of required frames are taken, and then press the button when done.
- When the mark is displayed, you cannot continue shooting any further. Panorama shooting is possible for up to 10 frames.
- Refer to the OLYMPUS Master 2 help guide for details on how to make panorama images.



**Restoring the shooting functions to the default settings [RESET]**

RESET

: **AUTO** **SCN**

Submenu 1	Application
YES	Restores the following menu functions to the default settings. <ul style="list-style-type: none"> <li>• SHADOW ADJ (p. 20)</li> <li>• Flash (p. 21)</li> <li>• Exposure compensation (p. 21)</li> <li>• Macro (p. 22)</li> <li>• Self-timer (p. 22)</li> <li>• [] IMAGE QUALITY (p. 28)</li> <li>• [] SCN (p. 31)</li> <li>• Menu functions in [] CAMERA MENU (p. 29 to 31)</li> </ul>
NO	The current settings are not changed.

# Menus for Playback, Editing, and Printing Functions

When the mode dial is set to the  position, settings can be made.

## Playing back automatically [ SLIDESHOW]

### SLIDESHOW

Submenu 1	Submenu 2	Submenu 3	Application
ALL/STILL PICTURE/MOVIE/ CALENDAR	NORMAL <sup>1</sup> / FADER <sup>1</sup> /SLIDE <sup>1</sup> / ZOOM <sup>1</sup> /date <sup>2</sup>	OFF/1/2	Selects the range of images for the slideshow, the type of transition effect ((TYPE)) used between images, and the background music ((BGM)).

<sup>1</sup> Only when [STILL PICTURE] is selected in submenu 1.

<sup>2</sup> Only when [CALENDAR] is selected in submenu 1.



### To start a slideshow

After pressing the  button to make the [BGM] settings, the slideshow starts. To stop the slideshow, press the  button or the **MENU** button.





 [BGM] is not available when [ SILENT MODE] (p. 49) is set to [ON].

## Retouching images [ PERFECT FIX]

### PERFECT FIX



-  Depending on the picture, the editing may not be effective.
-  The retouching process may lower the image resolution.

Submenu 1	Application
ALL	[LIGHTING FIX] and [REDEYE FIX] are applied together.
LIGHTING FIX	Only sections darkened by backlighting and dim lighting are brightened.
REDEYE FIX	Eyes that are reddened by the flash are corrected.



- 1 Use  to select a correction method and press the .
- 2 Use  to select an image for retouching, and press the  button.
  - The retouched image is saved as a separate image.

## Registering images to the internal memory as My Favorite images [ ADD FAVORITE]

### ADD FAVORITE

-  Up to 9 images can be registered.
-  "Playing back My Favorite images" (p. 26)
-  The registered My Favorite images can be used for the background image on the startup screen. [PW ON SETUP] (p. 42)

### To register images as My Favorite images

- 1 Use  to select an image to register, and then press the  button.
  - The selected image is registered to the internal memory as a separate My Favorite image.





- ❗ Registered pictures cannot be erased even by formatting the internal memory.
- ❗ Registered My Favorite images cannot be edited, printed, backed up to a card, transferred to a computer, or played back on a computer.

### Changing the image size [ ]



Submenu 2	Application
VGA 640 x 480	This saves a high-resolution image as a separate image with a smaller size for use in e-mail attachments and other applications.
QVGA 320 x 240	

- 1 Use [ ] to select an image, and press the [ ] button.
  - 2 Use [ ] to select an image size and press the [ ] button.
- The image with the selected size is saved as a separate image.

### Cropping a picture [ ]



- 1 Use [ ] to select an image, and press the [ ] button.
- 2 Use the zoom button to select the size of the cropping frame, and use [ ] to move the frame.



- 3 Press the [ ] button.
- The edited image is saved as a separate image.

### Changing the color tone of image [COLOR EDIT]



Submenu 2	Application
Black & white	This changes the image to black and white.
Sepia	This changes the image to a sepia tone.
Saturation (hard)	This increases the color saturation of the image.
Saturation (soft)	This slightly increases the color saturation of the image.

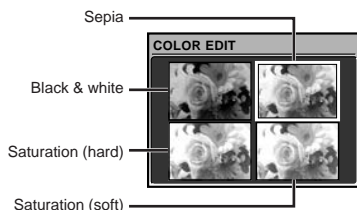

- 1 Use [ ] to select an image, and press the [ ] button.
  - 2 Use [ ] to select the desired color, and press the [ ] button.
- The image with the selected color is saved as a separate image.

## Adding a calendar to an image [CALENDAR]

✂ EDIT ▶ CALENDAR

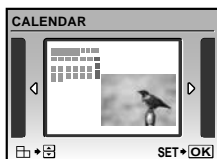

- 1 Use to select an image, and then press the button.
- 2 Use to select a calendar, and use to select the image orientation, and press the button.
- 3 Use to select the Year of the calendar, and then press .
- 4 Use to select the Month of the calendar, and then press the button.

- The edited image is saved as a separate image.

## Creating an index of 9 frames from a movie [INDEX]

✂ EDIT ▶ INDEX

- 1 Use to select a movie, and press the button.



- This function extracts 9 frames from a movie and saves them as a new picture (INDEX) containing thumbnails of each frame.

## Protecting images [O-M]

▶ PLAYBACK MENU ▶ O-M

- 1 Protected images cannot be erased by [ERASE] (p. 17), [SEL. IMAGE], or [ALL ERASE] (p. 39), but all images are erased by [MEMORY FORMAT]/[FORMAT] (p. 41).

Submenu 2	Application
OFF	Images can be erased.
ON	Images are protected so that they cannot be erased except by formatting of the internal memory/card.

- 1 Use to select an image.
- 2 Use to select [ON].
- 3 If necessary, repeat Steps 1 and 2 to protect other images, and press the button.



## Rotating images [↻]

▶ PLAYBACK MENU ▶

Submenu 2	Application
↻ +90°	The image is rotated 90° clockwise.
■ 0°	The image is not rotated.
↻ -90°	The image is rotated 90° counter-clockwise.

- Use to select an image.
- Use to select the rotation direction.
- If necessary, repeat Steps ① and ② to make settings for other images, and press the button.

! The new picture orientations will be saved even after the power is turned off.

## Adding sound to still images [🗣️]

▶ PLAYBACK MENU ▶

Submenu 2	Application
YES	The camera adds (records) sound for approx. 4 seconds while playing back the image. This is useful for recording notes or comments about the image.
NO	No sound is recorded.

- Use to select an image.
- Aim the microphone towards the sound source.

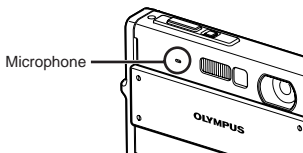

- Use to select [YES], and press the button.
  - Recording starts.

## Erasing images [🗑️ ERASE]

🗑️ ERASE

- ! Check each picture before erasing to avoid erasing any important pictures you may want to keep.

Submenu 1	Application
SEL. IMAGE	Images are individually selected and erased.
ALL ERASE	All images in the internal memory or card are erased.

### To individually select and erase images [SEL. IMAGE]

- Use to select [SEL. IMAGE], and press the button.
- Use to select the image to be erased, and press the button to add a ✓ mark to the image.



- Repeat Step ② to select the images to be erased, and then press the to erase the selected images.
- Use to select [YES], and press the button.
  - The images with a ✓ mark are erased.

### To erase all images [ALL ERASE]

- Use to select [ALL ERASE], and press the button.
- Use to select [YES], and press the button.



## ***Saving print settings to the image data***

### **[] PRINT ORDER**

---

#### PRINT ORDER

---

-  **"Print reservations (DPOF)" (p. 53)**
-  Print reservation can only be set for still images that are recorded to the card.





# Menus for Other Camera Settings

These settings can be made when the mode dial is set to a position other than **GUIDE**, **★**.

## Erasing data completely [MEMORY FORMAT]/[FORMAT]

⇧⇩ SETUP ► MEMORY FORMAT/FORMAT

- ! Before formatting, check that no important data is left in the internal memory or card.
- ! Non-Olympus cards and cards that have been formatted by a computer must be formatted with this camera before use.

Submenu 2	Application
YES	Completely erases the image data in the internal memory <sup>*1</sup> or card (including protected images).
NO	Cancels formatting.

\*1 Be sure to remove the card before formatting the internal memory.

## Copying images in the internal memory to the card [BACKUP]

⇧⇩ SETUP ► BACKUP

Submenu 2	Application
YES	Backs up image data in the internal memory to the card.
NO	Cancels the backup.

- ! It takes some time to back up data. Check that the battery has sufficient power before starting the backup, or use an AC adapter.

## Changing the display language [🗨️]

⇧⇩ SETUP ► 🗨️

! "Changing the display language" (p. 13)

Submenu 2	Application
Languages <sup>*1</sup>	The language for the menus and error messages displayed on the monitor is selected.

\*1 The available languages vary depending on the country and/or region where the camera was purchased.

## Setting the startup display screen and sound when the camera is turned on [PW ON SETUP]

⏪ SETUP ► PW ON SETUP



Submenu 2	Submenu 3	Application
SCREEN	OFF	No image is displayed.
	1	A preset image <sup>*1</sup> is displayed.
	2	A still image stored in the internal memory or card is registered for display. (This option leads to the setup screen.)
	MY FAVORITE	My Favorite image (p. 26) is displayed. (This option leads to the setup screen.)
VOLUME <sup>*2-3</sup>	OFF (No sound)/ LOW/HIGH	The volume of the startup sound is selected.

<sup>\*1</sup> This image cannot be changed.

<sup>\*2</sup> When [SCREEN] is set to [OFF], this setting is not available.

<sup>\*3</sup> When [SILENT MODE] (p. 49) is set to [ON], this setting is not available.

### To register a startup image

- 1 Select [2] or [MY FAVORITE] in submenu 3 for [SCREEN], and press the  button.
- 2 Use  to select the image to be registered, and press the  button.

## Selecting the menu screen color and background [MENU COLOR]

⏪ SETUP ► MENU COLOR

Submenu 2	Application
NORMAL/COLOR 1/ COLOR 2/COLOR 3	Selects the menu screen color or background image according to your preference.



## Selecting the camera sound and its volume [SOUND SETTINGS]

⏪ SETUP ► SOUND SETTINGS

Submenu 2	Submenu 3	Submenu 4	Application
BEEP	SOUND TYPE	1/2	Selects the operating sound and volume of the camera buttons (except the shutter button).
	VOLUME	OFF (No sound)/ LOW/HIGH	
SHUTTER SOUND	SOUND TYPE	1/2/3	Selects the operating sound and volume of the shutter button.
	VOLUME	OFF (No sound)/ LOW/HIGH	
■))	OFF (No sound)/ LOW/HIGH	—	Adjusts the warning sound volume.
▶ VOLUME	OFF (No sound)/ LOW/HIGH	—	Adjusts the image playback volume.

! To turn off all sounds at once, make the setting from [🔇 SILENT MODE] (p. 49).

## Viewing the image immediately after shooting [REC VIEW]

⏪ SETUP ► REC VIEW

Submenu 2	Application
OFF	The image being recorded is not displayed. This allows the user to prepare for the next shot while following the subject in the monitor after shooting.
ON	The image being recorded is displayed. This allows the user to make a brief check of the image that was just taken.

! Even when set to [ON], you can resume shooting while the image is being displayed.

## Resetting the file name numbers of pictures [FILE NAME]

Y T SETUP ► FILE NAME

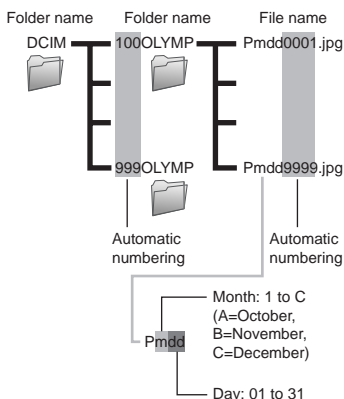

Submenu 2	Application
RESET	This resets the sequential number for the folder name and file name whenever a new card is inserted. <sup>*1</sup> This is useful when grouping images on separate cards.
AUTO	Even when a new card is inserted, this continues the numbering for the folder name and file name from the previous card. This is useful for managing all image folder names and files names with sequential numbers.

<sup>\*1</sup> The number for the folder name is reset to 100, and the one for the file name is reset to 0001.

## Adjusting the CCD and adjusting the image processing function [PIXEL MAPPING]

Y T SETUP ► PIXEL MAPPING

- ! This function has already been adjusted at factory shipping, and no adjustment is needed right after purchase. Approximately once a year is recommended.
- ! For best results, wait at least one minute after taking or viewing pictures before performing pixel mapping. If the camera is turned off during pixel mapping, be sure to perform it again.

### To adjust the CCD and to adjust the image processing function

Press the  button when [START] (submenu 2) is displayed.



- The camera checks and adjusts the CCD and the image processing function at the same time.



## Adjusting the brightness of the monitor

⇧ SETUP ▶ 

### To adjust the monitor brightness

- Use   to adjust the brightness while viewing the screen, and then press the  button.





## Setting the date and time

⇧ SETUP ▶ 

- "Setting the date and time" (p. 13)

### To select the date and time display order

- Press  after setting "Minute", and use   to select the date display order.

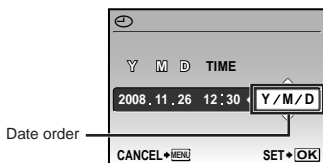

## Setting the date and time for another time zone [DUALTIME]

⇧ SETUP ▶ DUALTIME

- By setting [DUALTIME] to [ON] and setting the date and time, the set date and time is reflected in the image file names, date prints and so on.

Submenu 2	Submenu 3	Application
OFF	—	Switches to the date and time set in  (Date/time).
ON	(Proceeds to the setting screen <sup>*1</sup> .)	Switches to the date and time that were set in [DUALTIME] when using the camera in another time zone.

<sup>\*1</sup> The setting procedure is identical to that in "Setting the date and time" (p. 13).

- The date display order is the same as that set with .

## Using the alarm [ALARM CLOCK]

### ⏏ SETUP ▶ ALARM CLOCK

- ! When [☞] has not been set, [ALARM CLOCK] is not available.
- ! When [SILENT MODE] (p. 49) is set to [ON], the alarm will not sound.
- ! When [DUALTIME] (p. 45) is set to [ON], the alarm is activated at the date and time set in [DUALTIME].

Submenu 2	Submenu 3	Submenu 4	Application
OFF	—	—	The alarm is canceled.
ONE TIME	TIME	(Proceeds to the time setting screen <sup>1</sup> .)	The alarm is activated once according to the selected time, sound and volume settings.
	SNOOZE <sup>2</sup>	OFF/ON	
	SOUND TYPE	1/2/3	
	VOLUME	LOW/HIGH	
DAILY	(Submenus 3 and 4 can be set in the same way as [ONE TIME].)		The alarm is activated daily at the same settings.

<sup>1</sup> The setting procedure is identical to that in “Setting the date and time” (p. 13).

<sup>2</sup> In this setting, even if the alarm is stopped once, it will be activated every 5 minutes, up to 7 times.

- ! To check the alarm time, press the **DISP.** button while the camera is turned off. The current and alarm set times are displayed for approx. 3 seconds.

#### To activate the alarm

After making the detailed settings of [ONE TIME] or [DAILY], press the **POWER** button to turn off the camera.

#### To stop the alarm

When the alarm is activated, press any button to stop the alarm and turn off the camera.

- ! When [SNOOZE] is set to [OFF], the alarm stops automatically and the camera turns off after 1 minute of no operation.

## Selecting the video signal system to match your TV [VIDEO OUT]

### ⏏ SETUP ▶ VIDEO OUT

- ! The TV video signal system varies depending on the countries and regions. Before viewing camera images on your TV, select the video output according to your TV's video signal type.

Submenu 2	Application
NTSC	Connecting the camera to a TV in North America, Taiwan, Korea, Japan, and so on
PAL	Connecting the camera to a TV in European countries, China, and so on



- ! The factory default settings differ according to the region where the camera is sold.

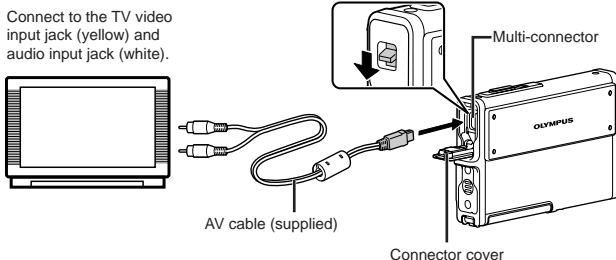

### To play back camera images on a TV

- 1 Connect the TV and camera.



- 2 Use the camera to select the same video signal system as the one of connected TV ([NTSC]/[PAL]).
- 3 Turn on the TV, and change "INPUT" to "VIDEO (an input jack connected to the camera)."
- 4 For details on changing the input source of the TV, refer to the TV's instruction manual.
- 4 Set the mode dial to , and use  to select the image for playback.
- 4 Depending on the TV's settings, the displayed images and information may become cropped.

### Saving battery power between shots [POWER SAVE]

⬆️ SETUP ► POWER SAVE

Submenu 2	Application
OFF	Cancels [POWER SAVE]
ON	When the camera is not being used for approx. 10 seconds, the monitor automatically turns off to save battery power.

### Using the LED illuminator as an auxiliary light [LED ILLUMINATOR]

⬆️ SETUP ► LED ILLUMINATOR

Submenu 2	Application
OFF	Disables the LED illuminator.
ON	Enables the LED illuminator.

- ! "Using the LED illuminator" (p. 23)

### To resume standby mode

Press any button or turn the mode dial.

## Operating the camera by tapping the body [TAP CONTROL]

⏪ SETUP ▶ TAP CONTROL

Submenu 2	Application
OFF	Cancels [TAP CONTROL]
ON	[TAP CONTROL] is activated.
CALIBRATE	Adjusts the tap strength and intervals between multiple taps on each side of the camera body. (top, left, right, & back)

### Functions available when [TAP CONTROL] is set to [ON]

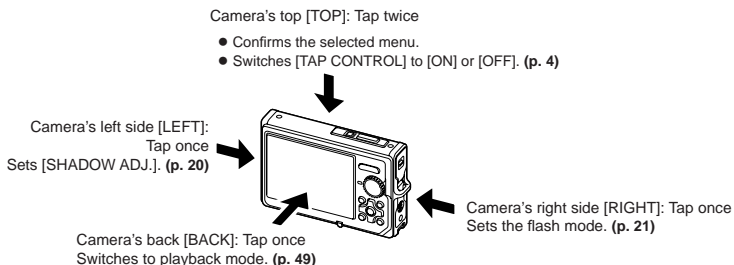

### Operating during shooting mode (Example: Flash mode)

- 1 Tap the right side of the camera body once.
    - The flash mode selection screen is displayed.
  - 2 Tap the right or left side of the camera body to select a function.
  - 3 Tap the top of the camera body twice to confirm your selection.
- ⚠ Tap the camera firmly using the pad of your finger.
  - ⚠ When the camera is stabilized on a tripod for example, tap control may not work properly.
  - ⚠ To prevent dropping the camera when using tap control, strap the camera to your wrist.

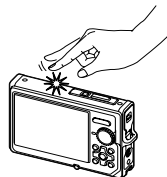

When tapping the camera's top





### Operating during playback mode

When switched to playback mode by tapping the back of the camera body once, the operations below can be used.

Display next image: Tap the right side of the camera once

Display previous image: Tap the left side of the camera once

Start slideshow: Tap the top surface of the camera twice. (The slideshow will automatically start for all images stored in internal memory or on the card, with [BGM] set to [OFF].)

Display next image during a slideshow: Tilt the camera right or tap the right side of the camera once.

Display previous image during a slideshow: Tap the left side of the camera once.

Stop slideshow: Tap the top surface of the camera twice.

### To adjust the tap control

- ① Select [CALIBRATE] in submenu 2 and press the button.
  - ② Select the part to adjust with and press the button.
  - ③ Select the [STR] setting with and press the button.
  - ④ Select the [INTVL] setting with and press the button.
- Check the operation of the camera by tapping on the camera after making the settings.

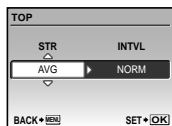

### Turning off the camera sounds [ SILENT MODE]

#### SILENT MODE

Submenu 1	Application
OFF	Activates the [SOUND SETTINGS] setting.
ON	The electronic sounds (operating sound, shutter sound, warning sound) and playback sounds are muted.

- [SOUND SETTINGS] (p. 43)

# Printing

## Direct printing (PictBridge<sup>1</sup>)

By connecting the camera to a PictBridge-compatible printer, you can print images directly without using a computer.

To find out if your printer supports PictBridge, refer to the printer's instruction manual.

<sup>1</sup> PictBridge is a standard for connecting digital cameras and printers of different makers and printing out pictures directly.

- ⚠ The printing modes, paper sizes, and other parameters that can be set with the camera vary depending on the printer that is used. For details, refer to the printer's instruction manual.
- ⚠ For details on the available paper types, loading paper, and installing ink cassettes, refer to the printer's instruction manual.

## Printing images at the printer's standard settings [EASY PRINT]

### 1 Display the image to be printed on the monitor.

- ⚠ "Viewing images" (p. 16)
- ⚠ Printing can also be started when the camera is turned off. After performing Step 2, use to select [EASY PRINT], press the button. Use to select an image, and proceed to Step 3.

### 2 Turn on the printer, and then connect the printer and camera.

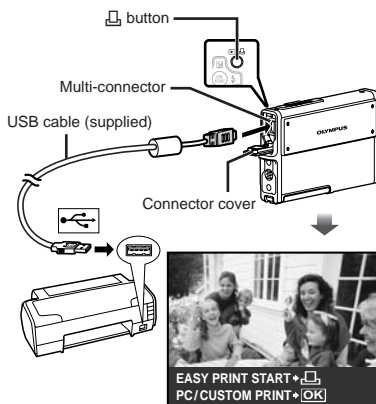

### 3 Press the button to start printing.

### 4 To print another image, use to select an image, and press the button.

#### To exit printing

After a selected image is displayed on the screen, disconnect the USB cable from the camera and printer.



## Changing the printer's settings for printing [CUSTOM PRINT]

- 1 Follow Steps 1 and 2 for [EASY PRINT] (p. 50), then press the  button.

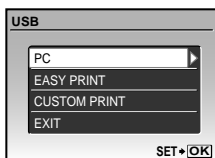



- 2 Use   to select [CUSTOM PRINT], and press the  button.

- 3 Use   to select the print mode, and press the  button.



Submenu 2	Application
PRINT	This prints the image selected in Step 6.
ALL PRINT	This prints all images stored in the internal memory or card.
MULTI PRINT	This prints one image in a multiple layout format.
ALL INDEX	This prints an index of all images stored in the internal memory or card.
PRINT ORDER <sup>1</sup>	This prints images based on the print reservation data on the card.

<sup>1</sup> [PRINT ORDER] is available only when print reservations have been made. "Print Reservations (DPOF)" (p. 53)

- 4 Use   to select [SIZE] (Submenu 3), and press .

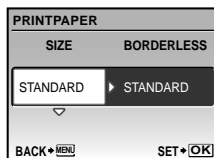
- ! If the [PRINTPAPER] screen is not displayed, the [SIZE], [BORDERLESS], and [PICS/SHEET] are set to the printer's standard.



- 5 Use   to select the [BORDERLESS] or [PICS/SHEET] settings, and press the .

Submenu 4	Application
OFF/ON <sup>1</sup>	The image is printed with a border around it ([OFF]). The image is printed to fill the entire paper ([ON]).
(The number of images per sheet varies depending on the printer.)	The number of images per sheet ([PICS/SHEET]) is selectable only when [MULTI PRINT] is selected in Step 3.

<sup>1</sup> The available settings for [BORDERLESS] vary depending on the printer.

- ! If [STANDARD] is selected in Steps 4 and 5, the image is printed at the printer's standard settings.



6 Use to select an image.

7 Press the button to [SINGLE PRINT] the current image.

Press if you wish to make detailed printer settings for the current image.

To make detailed printer settings

- Use to make the detailed printer settings, and press the button.

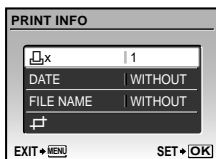

Submenu 5	Submenu 6	Application
	0 to 10	This selects the number of prints.
DATE	WITH/ WITHOUT	Selecting [WITH] prints the images with the date. Selecting [WITHOUT] prints the images without the date.
FILE NAME	WITH/ WITHOUT	Selecting [WITH] prints the file name on the image. Selecting [WITHOUT] does not print any file name on the image.
	(Proceeds to the setting screen. See below.)	This selects a portion of the image for printing.

To crop an image ()

- Use the zoom button to select the size of the cropping frame, use to move the frame, and then press the button.



- Use to select [OK], and press the button.



8 If necessary, repeat Steps 6 to 7 to select the image to be printed, make the detailed settings, and set [SINGLEPRINT].

9 Press the button.

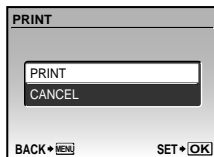

10 Use to select [PRINT], and press the button.

- Printing starts.
- When [OPTION SET] is selected in [ALL PRINT] mode, [PRINT INFO] screen is displayed.
- When printing is finished, the [PRINT MODE SELECT] screen is displayed.

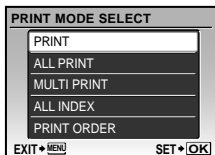

To cancel printing

- 1 Press the button while [TRANSFERRING] is displayed.
- 2 Use to select [CANCEL], then press the button.

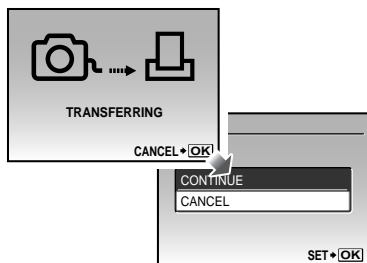

11 Press the MENU button.

12 When the message [REMOVE USB CABLE] is displayed, disconnect the USB cable from the camera and printer.

Print Reservations (DPOF<sup>\*1</sup>)

In print reservations, the number of prints and date imprint option are saved in the image on the card. This enables easy printing at a printer or print shop supporting DPOF by using only the print reservations on the card without a computer or a camera.

\*1 DPOF is a standard for storing automatic printout information from digital cameras.

- ! Print reservations can be set only for the images stored on the card. Insert a card with recorded images before making print reservations.
- ! DPOF reservations set by another DPOF device cannot be changed by this camera. Make changes using the original device. Making new DPOF reservations with this camera will erase the reservations made by the other device.
- ! DPOF print reservations can be made for up to 999 images per card.

Single-frame print reservations

- 1 Set the mode dial to , and then press the MENU button to display the top menu.
- 2 Use to select [PRINT ORDER], and press the button.

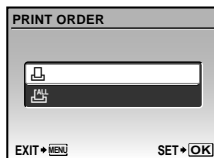

- 3 Use to select [ ], and press the button.

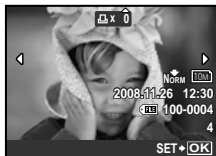

- 4 Use to select the image for print reservation. Use to select the quantity. Press the button.



- 5 Use to select the [ ] (date print) screen option, and press the button.

Submenu 2	Application
NO	This prints the image only.
DATE	This prints the image with the shooting date.
TIME	This prints the image with the shooting time.



- 6 Use to select [SET], and press the button.

*Reserving one print each of all images on the card [ ]*

- 1 Follow Steps 1 and 2 in [ ] (p. 53).
- 2 Use to select [ ], and press the button.
- 3 Follow Steps 5 to 6 in [ ].

*Resetting all print reservation data*

- 1 Set the mode dial to , and then press the MENU button to display the top menu.
- 2 Use to select [PRINT ORDER], and press the button.
- 3 Select either [ ] or [ ], and press the button.

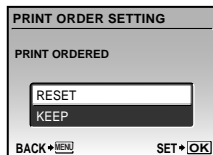



- 4 Use to select [RESET], and press the button.

## *Resetting the print reservation data for selected images*



---

- 1 Follow Steps 1 and 2 of “Resetting all print reservation data” (p. 54).



---

- 2 Use  to select [, and press the  button.

---

- 3 Use  to select [KEEP] and press the  button.



---

- 4 Use  to select the image with the print reservation you want to cancel. Use  to set the print quantity to “0”.



---

- 5 If necessary, repeat Step 4, and then press the  button when finished.

---

- 6 Use  to select the [] (date print) screen option, and press the  button.
  - The settings are applied to the remaining images with the print reservation data.

---

- 7 Use  to select [SET], and press the  button.



# Using OLYMPUS Master 2

## System requirements and installation of OLYMPUS Master 2

Install the OLYMPUS Master 2 software by referring to the included installation guide.

## Connecting the camera to a computer

### 1 Make sure the camera is turned off.

- The monitor is off.

### 2 Connect the camera to a computer.

- The camera automatically turns on.

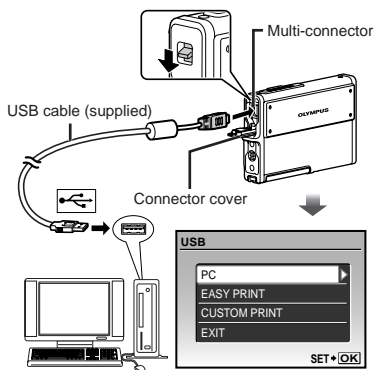

- ! Locate the position of the USB port by referring to your computer's instructions manual.

### 3 Use to select [PC], and press the button.

- The computer automatically detects the camera as a new device on the first connection.

## Windows

After the computer detects the camera, a message indicating the completion of the setting appears. Confirm the message and click "OK". The camera is recognized as a removable disk.

## Macintosh

When iPhoto started, exit iPhoto and start OLYMPUS Master 2.

- ! While the camera is connected to the computer, shooting functions are disabled.
- ! Connecting the camera to a computer via a USB hub may cause unstable operation.
- ! When [MTP] is set for the submenu that appears by pressing after selecting [PC] in Step 3, images cannot be transferred to a computer using OLYMPUS Master 2.

## Starting OLYMPUS Master 2

### 1 Double-click the OLYMPUS Master 2 icon .

## Windows

appears on the desktop.

## Macintosh

appears in the OLYMPUS Master 2 folder.

- Browse window appears after starting the software.
- ! When you start OLYMPUS Master 2 for the first time after installation, "Default Settings" and "Registration" screens appear. Follow the instructions on the screen.



## Operating OLYMPUS Master 2

When OLYMPUS Master 2 is started, Quick Start Guide appears on the screen that helps you to handle the camera without any question. When the Quick Start Guide is not displayed, click  in the toolbar to show the Guide.



For details on the operation, refer to the help guide of the software.

## Transferring and saving images without using OLYMPUS Master 2

This camera is compatible with the USB Mass Storage Class. You can transfer and save the image data on your computer while the camera and the computer are connected.

### System requirements

Windows : Windows 2000 Professional/  
XP Home Edition/  
XP Professional/Vista

Macintosh : Mac OS X v10.3 or later

- ❗ On a computer running Windows Vista, if [MTP] is set for the submenu that appears by pressing  after selecting [PC] in Step 3 of “**Connecting the camera to a computer**” (p. 56), Windows Photo Gallery will become available.
- ❗ Even if a computer has USB ports, proper operation is not guaranteed in the following cases.
  - Computers with USB ports installed using an expansion card, etc.
  - Computers without a factory-installed OS and home-built computers



# Usage Tips

If the camera does not work as intended, or if an error message is displayed on the screen, and you are unsure of what to do, refer to the information below to fix the problem(s).

## Troubleshooting

### Battery

**“The camera does not work even when battery is installed”**

- Insert recharged battery in the correct direction.  
**“Charging the battery” (p. 10), “Loading the battery and the xD-Picture Card™ (sold separately) into the camera” (p. 11)**
- Battery performance may have been reduced temporarily due to low temperature. Take the battery out of the camera, and warm it by putting it in your pocket for a while.

### Card/Internal memory

**“An error message is displayed”**

**“Error message” (p. 59)**

### Shutter button

**“No picture is taken when the shutter button is pressed”**

- Slide the lens barrier down.
- Cancel sleep mode.

To save battery power, the camera automatically goes into sleep mode and the monitor turns off if there is no operation after 3 minutes when the camera is turned on (when the lens barrier is open and the monitor is on). No picture is taken even if the shutter button is fully pressed in this mode. Operate the zoom button or other buttons to restore the camera from sleep mode before taking a picture. If the camera is left for 15 minutes, it automatically turns off (the monitor turns off). Slide the lens barrier down again or press **POWER** to turn the camera on.

- Set the mode dial to a position other than **□**, **GUIDE** and **★**.
- Wait until  (flash charge) stops blinking before taking pictures.

### Monitor

**“Difficult to see”**

- Condensation\*<sup>1</sup> may have formed. Turn off the power and wait for the camera body to become acclimated to the surrounding temperature and dry out before taking pictures.

\*<sup>1</sup> Dew drops can form in the camera when it is suddenly taken from a cold location into a warm, humid room.

**“Vertical lines appear on the screen”**

- Vertical lines may appear on the screen at times such as when the camera is pointed at an extremely bright subject under a clear sky. The lines do not appear, however, in the final image.

**“The light is caught in the picture”**

- Shooting with flash in dark situations results in an image with many flash reflections on dust in the air.

### Date and time function

**“Date and time settings return to the default setting”**

- If the battery is removed and left out of the camera for about 1 day\*<sup>2</sup>, the date and time settings return to the default setting and must be reset.





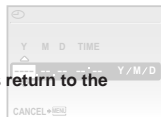
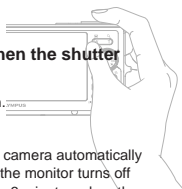
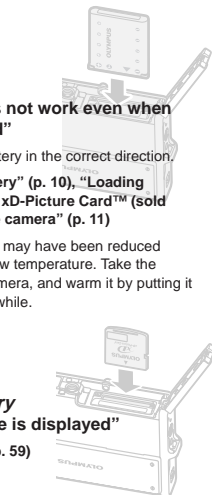









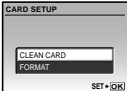





\*<sup>2</sup> The time until the date and time settings return to the default setting varies depending on how long the battery have been loaded.



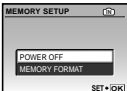

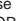

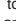
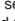

**“Setting the date and time” (p. 13)**



## Error message

- When one of the messages below is displayed on the monitor, check the corrective action.

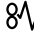
Error message	Corrective action
 <b>CARD ERROR</b>	<b>Card problem</b> Insert a new card.
 <b>WRITE PROTECT</b>	<b>Card problem</b> Use a computer to cancel the read-only setting.
 <b>MEMORY FULL</b>	<b>Internal memory problem</b> <ul style="list-style-type: none"> <li>Insert a card.</li> <li>Erase unwanted images.<sup>1</sup></li> </ul>
 <b>CARD FULL</b>	<b>Card problem</b> <ul style="list-style-type: none"> <li>Replace the card.</li> <li>Erase unwanted images.<sup>1</sup></li> </ul>
	<b>Card problem</b> <ul style="list-style-type: none"> <li>Use   to select [CLEAN CARD], and press the  button. Take out the card, wipe the contact area (p. 64) with a soft, dry cloth, and then load the card again.</li> <li>Use   to select [FORMAT], and press the  button. Next, use   to select [YES], and press the  button.<sup>2</sup></li> </ul>
	<b>Internal memory problem</b> Use   to select [MEMORY FORMAT], and press the  button. Next, use   to select [YES], and press the  button. <sup>2</sup>
 <b>NO PICTURE</b>	<b>Internal memory/Card problem</b> Take pictures before viewing them.
 <b>PICTURE ERROR</b>	<b>Problem with selected image</b> Use photo retouch software, etc. to view the image on a computer. If the image still cannot be viewed, the image file is corrupted.

Error message	Corrective action
 <b>THE IMAGE CANNOT BE EDITED</b>	<b>Problem with selected image</b> Use photo retouch software, etc. to edit the image on a computer.
 <b>CARD-COVER OPEN</b>	<b>Operation problem</b> Close the battery/card compartment cover.
<b>THE LENS BARRIER IS CLOSED</b>	<b>Operation problem</b> Slide the lens barrier down to take a picture.
 <b>BATTERY EMPTY</b>	<b>Battery problem</b> Charge the battery.
 <b>NO CONNECTION</b>	<b>Connection problem</b> Connect the camera and computer or printer correctly.
 <b>NO PAPER</b>	<b>Printer problem</b> Load paper into the printer.
 <b>NO INK</b>	<b>Printer problem</b> Refill the ink in the printer.
 <b>JAMMED</b>	<b>Printer problem</b> Remove the jammed paper.
<b>SETTINGS CHANGED<sup>3</sup></b>	<b>Printer problem</b> Return to the status where the printer can be used.
 <b>PRINT ERROR</b>	<b>Printer problem</b> Turn off the camera and printer, check the printer for any problems, and then turn the power on again.
 <b>CANNOT PRINT<sup>4</sup></b>	<b>Problem with selected image</b> Use a computer to print.

<sup>1</sup> Before erasing important images, download them to a computer.

<sup>2</sup> All data will be erased.

<sup>3</sup> This is displayed, for instance, when the printer's paper tray has been removed. Do not operate the printer while making the print settings on the camera.

<sup>4</sup> This camera may be unable to print images taken by other cameras.

## Shooting tips

When you are unsure of how to take a picture that you envision, refer to the information below.

### Focusing



#### “Focusing on the subject”

- **Taking a picture of a subject not in the center of the screen**

After focusing on an object at the same distance as the subject, compose the shot, and take the picture.

**Pressing the shutter button halfway (p. 15)**

**AF lock (p. 18)**

- **Set [AF MODE] (p. 31) to [iESP]**
- **Taking a picture of subjects where autofocus is difficult**

In the following cases, after focusing on an object (by pressing the shutter button halfway down) with high contrast at the same distance as the subject, compose the shot, and take the picture.

Subjects with low contrast



When extremely bright objects appear in the center of the screen

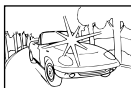

Object with no vertical lines<sup>1</sup>

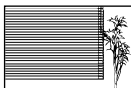

<sup>1</sup> It is also effective to compose the shot by holding the camera vertically to focus, and then returning to the horizontal position to take the picture.

When objects are at different distances



Fast-moving object

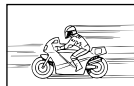

The subject is not in the center of the frame



## Camera shake



### “Taking pictures (or movies) without camera shake”

- Taking pictures using mode (p. 19)
- Shooting movies using [DIS MOVIE MODE] (p. 30)
- Taking picture with SPORT] (p. 31)

Since you can take pictures with a high shutter speed by setting SPORT], it's also effective for blurry subjects.

- Taking pictures at a high ISO sensitivity

If a high ISO sensitivity is selected, pictures can be taken at a high shutter speed even at locations where a flash cannot be used.

[ISO] (p. 29)

## Exposure (brightness)



### “Taking pictures with the right brightness”

- Taking pictures of a subject against a backlight

A face against the backlight is brightened.

[SHADOW ADJ] (p. 20)

- Taking pictures using [FACE DETECT] for [AF MODE] (p. 31)

Appropriate exposure is obtained for a face against the backlight, and the face is brightened.

- Taking pictures using for [ESP/] (p. 30)

The picture can be taken based on the brightness at the center of the monitor, so it's not affected by the light in the background.

- Taking pictures using [FILL IN] (p. 21) flash

A subject against a backlight is brightened.

- Taking pictures of a white beach or snow scene

Set the mode to BEACH & SNOW], SNOW] (p. 31)

- Taking pictures using exposure compensation (p. 21)

Adjust the brightness while viewing the screen for taking the picture. Normally, taking pictures of white subjects (such as snow) results in images that are darker than the actual subject. Use the button to adjust in the positive direction to express whites as they appear. When taking pictures of black subjects, on the other hand, it is effective to adjust in the negative direction.

## Color hue



### “Taking pictures with colors at the same shade as they appear”

- Taking pictures by selecting [WB] (p. 29)

Best results in most environments can normally be obtained with the AUTO setting, but for some subjects, you should try experimenting with different settings. (This is especially true for sunshade under a clear sky, mixed natural and artificial light settings, and so on.)

## Image quality



### “Taking sharper pictures”

- Taking pictures with the optical zoom

Avoid using [DIGITAL ZOOM] (p. 30) to take pictures.

- Taking pictures at a low ISO sensitivity

If the picture is taken with a high ISO sensitivity, noise (small colored spots and color unevenness that were not in the original image) can occur, and the image can appear grainy.

[ISO] (p. 29)

## Panorama



### “Taking pictures so that the frames are stitched smoothly”

- A tip for panoramic shooting

Taking pictures by pivoting with the camera at the center prevents shifting of the image. When taking pictures of close objects in particular, pivoting with the lens end at the center produces favorable results.

## Battery



### “Making battery last longer”

- Avoid performing the following operations as much as possible as they use up battery power even if no pictures are actually taken
  - Repeatedly pressing the shutter button halfway.
  - Repeatedly using the zoom.
- Set [POWER SAVE] (p. 47) to [ON]

## Playback/Editing tips

## Playback



### “Playing images in the internal memory”

- Removing the card from the camera  
“Removing the xD-Picture card” (p. 11)

### “Using the microSD card”

“Using a microSD card/microSDHC card (sold separately)” (p. 12)

## Editing



### “Erasing the sound recorded to a still image”

- Record over the sound with silence when playing back the image  
[] (Post REC)] (p. 39)

## Camera care

### Exterior

- Wipe gently with a soft cloth. If the camera is very dirty, soak the cloth in mild soapy water and wring well. Wipe the camera with the damp cloth and then dry it with a dry cloth. If you have used the camera at the beach, use a cloth soaked in clean water and wrung well.
- If any dirt, dust, sand, or other foreign material adheres to the periphery of the lens cover after use, or the lens cover does not move smoothly, wash the camera using the method described on P. 67.

### Monitor

- Wipe gently with a soft cloth.

### Lens

- Blow dust off the lens with a commercial blower, then wipe gently with a lens cleaner.

### Battery/Charger

- Wipe gently with a soft, dry cloth.
  - ❗ Do not use strong solvents such as benzene or alcohol, or chemically treated cloth.
  - ❗ Mold may form on the lens surface if the lens is left dirty.

## Storage

- When storing the camera for extended periods, remove the battery, AC adapter and card, and keep in a cool, dry place that is well ventilated.
- Periodically insert the battery and test the camera functions.
  - ❗ Avoid leaving the camera in places where chemical products are handled since this may result in corrosion.

## Battery and charger

- This camera uses one Olympus lithium ion battery (LI-42B/LI-40B). No other type of batteries can be used.
- Power consumption by the camera varies depending on which functions are used.
- During the conditions described below, power is consumed continuously and the battery becomes exhausted quickly.
  - The zoom is used repeatedly.
  - The shutter button is pressed halfway repeatedly in shooting mode, activating the auto focus.
  - A picture is displayed on the monitor for an extended period of time.
  - The camera is connected to a computer or printer.
- Using an exhausted battery may cause the camera to turn off without displaying the battery level warning.
- The rechargeable battery is not fully charged at the time of purchase. Charge the battery fully with the LI-40C charger before use.
- The provided rechargeable battery usually takes approximately 5 hours to charge (varies on usage).
- The supplied LI-40C battery charger is used only for LI-42B/LI-40B battery. Do not charge other type of battery with the supplied battery charger. It might cause explosion, leaking, overheating or fire.

## Using an AC adapter

An AC adapter is useful for time-consuming tasks such as image downloads to a computer or when running a slideshow for a long period of time. To use an AC adapter for this camera, the multi-adapter (CB-MA1/accessory) is required. Do not use any other AC adapter with this camera.

## Using your charger and AC adapter abroad

- The charger and AC adapter can be used in most home electrical sources within the range of 100 V to 240 V AC (50/60Hz) around the world. However, depending on the country or area you are in, the AC wall outlet may be shaped differently and the charger and AC adapter may require a plug adapter to match the wall outlet. For details, ask at your local electrical shop or travel agent.
- Do not use travel voltage converters as they could damage your charger and AC adapter.

## Using an xD-Picture Card

A card (and internal memory) also corresponds to the film that records images in a film camera. Otherwise, the recorded images (data) can be erased, and retouching is also available with the use of a computer. Cards can be removed from the camera and exchanged, but this is not possible with the internal memory. Use of larger capacity cards enables you to take more pictures.

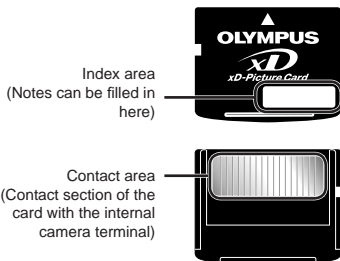

⚠ Do not touch the contact area directly.

## Cards compatible with this camera

xD-Picture Card (16MB to 2GB)  
(TypeH/M/M+, Standard)

## Using a new card

Before using a non-Olympus card or a card that was used for another purpose in a computer or other device, use **[MEMORY FORMAT]/[FORMAT]** (p. 41) to format the card.

## Checking the image saving location

The memory indicator shows whether the internal memory or card is being used during shooting and playback.

## Current memory indicator

☑: Internal memory is being used  
None: Card is being used

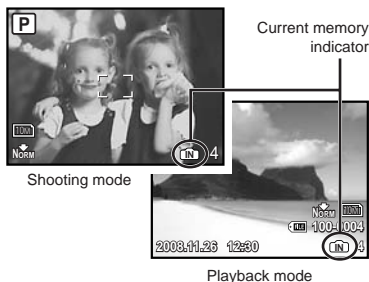

- ⚠ Even if **[MEMORY FORMAT]/[FORMAT]**, **[ERASE]**, **[SEL. IMAGE]**, or **[ALL ERASE]** is performed, the data in the card is not completely erased. When disposing of the card, damage the card to prevent the disclosure of personal data.



## Readout/recording process of the card

Never open the battery/card compartment cover while the camera is reading or writing data, which is indicated by blinking of the card access lamp. This can not only damage the image data but also render the internal memory or card unusable.

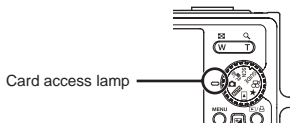

## Number of storable pictures (still pictures)/recording length (movies) in the internal memory and xD-Picture Card

### Still pictures

IMAGE SIZE		COMPRES- SION	Number of storable still pictures			
			Internal memory		Using a 1GB card (xD-Picture Card)	
			With sound	Without sound	With sound	Without sound
10M	3648x2736	FINE	8	8	204	205
		NORM	16	16	399	404
5M	2560x1920	FINE	16	17	404	410
		NORM	34	35	820	841
3M	2048x1536	FINE	25	26	615	627
		NORM	52	54	1254	1305
2M	1600x1200	FINE	43	44	1031	1066
		NORM	80	86	1938	2063
1M	1280x960	FINE	65	68	1560	1640
		NORM	121	133	2907	3198
VGA	640x480	FINE	205	242	4920	5815
		NORM	333	444	7996	10661
16:9	1920x1080	FINE	39	41	954	984
		NORM	76	80	1827	1938

### Movies

IMAGE SIZE		FRAME RATE	Continuous recording length	
			Internal memory	Using a 1 GB card (xD-Picture Card)
VGA	640x480	30P	23 sec.	9 min. 21 sec.*
		15P	46 sec.	18 min. 37 sec.
QVGA	320x240	30P	55 sec.	22 min. 3 sec.
		15P	1 min. 49 sec.	43 min. 37 sec.

🔊 The maximum file size of a single movie is 2 GB, regardless of the capacity of the card.

\* The maximum length is 10 seconds when using a TypeM or Standard xD-Picture Card.

## Increasing the number of pictures that can be taken

Either erase unwanted images, or connect the camera to a computer or other device to save the images, and then erase the images in the internal memory or card.

[ERASE] (p. 17), [SEL. IMAGE] (p. 39), [ALL ERASE] (p. 39), [MEMORY FORMAT]/[FORMAT] (p. 41)

## Using a microSD Attachment

❗ Do not use the attachment with Olympus digital cameras that do not support this microSD Attachment, as well as with other brands of digital cameras, computers, printers, and other devices that support xD-Picture Card. Doing so not only may damage the pictures taken, but may also result in the malfunction of the device.

❗ If the microSD card cannot be removed, do not use force. Contact authorized distributors/service centers.

## Cards compatible with this camera

microSD card/microSDHC card

❗ For a list of tested microSD cards, please visit our website (<http://www.olympus.com/>).

## Sending images

You can send images to a computer or printer by using the USB cable provided with the camera.

To send data to other devices, remove the attachment from the camera and use a commercially available microSD card adapter.

## Handling precautions

Do not touch the contact area of the attachment or microSD card. Doing so may cause failure in reading the images. When fingerprints or stains are found on the contact area, wipe the area with a soft dry cloth.

## Important information about water and shock resistant features

**Water resistance:** The waterproof feature is warranted<sup>1</sup> to operate at depths up to 3 m (9.8 feet) for up to one hour. The waterproof feature may be compromised if the camera is subject to substantial or excessive impact.

**Shock resistance:** The anti-shock feature warrants<sup>2</sup> the operation of the camera against accidental impact incurred from everyday use of your digital compact camera. The anti-shock feature does not unconditionally warrant all defective operation or cosmetic damage. Cosmetic damage, such as scratches and dents, are not covered under the warranty.

As with any electronic device, proper care and maintenance are required to preserve the integrity and operation of your camera. To maintain camera performance, please take your camera to the nearest Olympus Authorized Service Center to have it inspected after any major impact. In the event the camera is damaged as a result of negligence or misuse, the warranty will not cover costs associated with the service or repair of your camera. For additional information on our warranty, please visit to the Olympus website for your local area. Please observe the following care instructions for your camera.

\*1 As determined by Olympus pressure testing equipment in accordance with IEC Standard Publication 529 IPX8 - This means that the camera can be used normally under water at a specified water pressure.

\*2 This anti-shock performance is confirmed by Olympus' testing conditions in accordance with MIL-STD-810F, Method 516.5, Procedure IV (Transit Drop Test). For more details of Olympus' testing conditions, please refer to the Olympus website for your local area.

### Before Use:

- Check the camera for foreign material including dirt, dust or sand.
- Be sure to close the battery/card compartment cover and connector cover firmly so that each lock makes clicking sound.
- Do not open the battery/card compartment cover and connector cover with wet hands, while under water, or in a damp or dusty environment (e.g. beach).
- Use the camera underwater with the lens barrier in the down position. To turn the camera on and off underwater, use the **POWER** button.

### After Use:

- Do not slide the lens barrier up until the camera has been rinsed with water.
- Be sure to wipe off any excess water or debris after using the camera under water.
- **After the camera is used under seawater, immerse the camera in a bucket containing fresh water for about 10 minutes (with the battery/card compartment cover and connector cover firmly closed). After that, dry the camera in a shade with good ventilation.**
- **Water drops may be observed on the inner surface of the battery/card compartment cover or connector cover after you open each cover. If any water drops are found, be sure to wipe them off before using the camera.**

### Notes after use

- Foreign materials may be attached to the periphery of the lens barrier from using the camera in conditions with foreign materials such as dirt, dust or sand, or when the lens barrier is not moving smoothly. If you continue to use the camera in such conditions, the lens could become damaged or the lens barrier could stick causing additional damage to the camera. To avoid such damage, wash the camera using the following method.
  - ① Insert the battery and close the battery/ card compartment cover and connector cover firmly so that each lock makes the clicking sound.
  - ② Fill a bucket with fresh water, immerse the camera in the bucket with the lens surface downward and shake the camera thoroughly.

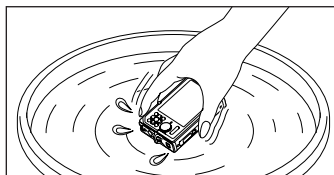

- ③ Rinse the front of the camera with running water while the lens barrier is open.

Follow Steps ① to ③, then check if the lens barrier moves smoothly. If the lens barrier does not move smoothly, rinse the lens barrier by placing it directly under fast running water.

### Storage and Maintenance

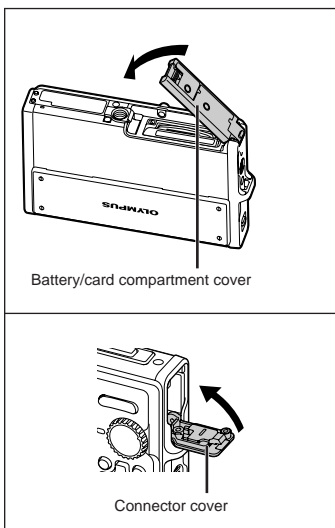

- Do not leave the camera in an environment at high temperature (40°C (104°F) or more) or at low temperature (-10°C (14°F) or less). Failure to do so may break down water resistance.
- Do not use chemicals for cleaning, rust prevention, anti-fogging, repairing, etc. Failure to do so may break down water resistance.
- **Do not leave the camera in water for a long time. Failure to do so will cause damage to the camera's appearance and/or deteriorate water resistance.**
- **In order to preserve the water resistant feature, as with any underwater housing, it is recommended that the waterproof packing (and seals) are replaced annually. For the Olympus distributors or service stations where the waterproof packing can be replaced, visit Olympus website for your local area.**

## Closing Battery/card compartment cover and Connector cover



- ⚠ The included accessories (e.g. charger) do not offer shock or water resistance.

## SAFETY PRECAUTIONS

	<b>CAUTION</b> RISK OF ELECTRIC SHOCK DO NOT OPEN	
<p>CAUTION: TO REDUCE THE RISK OF ELECTRICAL SHOCK, DO NOT REMOVE COVER (OR BACK). NO USER-SERVICEABLE PARTS INSIDE. REFER SERVICING TO QUALIFIED OLYMPUS SERVICE PERSONNEL.</p>		

- ⚠ An exclamation mark enclosed in a triangle alerts you to important operating and maintenance instructions in the documentation provided with the product.
- ⚠ **DANGER** If the product is used without observing the information given under this symbol, serious injury or death may result.
- ⚠ **WARNING** If the product is used without observing the information given under this symbol, injury or death may result.
- ⚠ **CAUTION** If the product is used without observing the information given under this symbol, minor personal injury, damage to the equipment, or loss of valuable data may result.

**WARNING!**  
TO AVOID THE RISK OF FIRE OR ELECTRICAL SHOCK, NEVER DISASSEMBLE, EXPOSE THIS PRODUCT TO WATER OR OPERATE IN A HIGH HUMIDITY ENVIRONMENT.

### General Precautions

- Read All Instructions** — Before you use the product, read all operating instructions. Save all manuals and documentation for future reference.
- Cleaning** — Always unplug this product from the wall outlet before cleaning. Use only a damp cloth for cleaning. Never use any type of liquid or aerosol cleaner, or any type of organic solvent to clean this product.
- Attachments** — For your safety, and to avoid damaging the product, use only accessories recommended by Olympus.
- Water and Moisture** — For precautions on products with weatherproof designs, read the weatherproofing sections.
- Location** — To avoid damage to the product, mount the product securely on a stable tripod, stand, or bracket.
- Power Source** — Connect this product only to the power source described on the product label.
- Lightning** — If a lightning storm occurs while using an AC adapter, remove it from the wall outlet immediately.
- Foreign Objects** — To avoid personal injury, never insert a metal object into the product.
- Heat** — Never use or store this product near any heat source such as a radiator, heat register, stove, or any type of equipment or appliance that generates heat, including stereo amplifiers.

## Handling the Camera

### WARNING

- Do not use the camera near flammable or explosive gases.
- Do not use the flash and LED on people (infants, small children, etc.) at close range.
  - You must be at least 1 m (3 ft.) away from the faces of your subjects. Firing the flash too close to the subject's eyes could cause a momentary loss of vision.
- Keep young children and infants away from the camera.
  - Always use and store the camera out of the reach of young children and infants to prevent the following dangerous situations which could cause serious injury:
    - Becoming entangled in the camera strap, causing strangulation.
    - Accidentally swallowing the battery, cards or other small parts.
    - Accidentally firing the flash into their own eyes or those of another child.
    - Accidentally being injured by the moving parts of the camera.
- Do not look at the sun or strong lights with the camera.
- Do not use or store the camera in dusty or humid places.
- Do not cover the flash with a hand while firing.
- Do not insert anything into the microSD Attachment other than the microSD card. This attachment is exclusive for use of microSD cards only. Other types of cards cannot be installed.
- Do not insert anything other than an xD-Picture Card or the microSD Attachment into the camera

If you insert a card by mistake, such as a microSD card, do not use force. Contact authorized distributors/service centers. Damages such as scratches on the attachment or card could result in the camera overheating and/or malfunctioning.

### CAUTION

- Stop using the camera immediately if you notice any unusual odors, noise, or smoke around it.
  - Never remove the batteries with bare hands, which may cause a fire or burn your hands.
- Do not leave the camera in places where it may be subject to extremely high temperatures.
  - Doing so may cause parts to deteriorate and, in some circumstances, cause the camera to catch fire. Do not use the charger or AC adapter if it is covered (such as a blanket). This could cause overheating, resulting in fire.
- Handle the camera with care to avoid getting a low-temperature burn.
  - When the camera contains metal parts, overheating can result in a low-temperature burn. Pay attention to the following:
    - When used for a long period, the camera will get hot. If you hold on to the camera in this state, a low-temperature burn may be caused.
    - In places subject to extremely cold temperatures, the temperature of the camera's body may be lower than the environmental temperature. If possible, wear gloves when handling the camera in cold temperatures.
- Be careful with the strap.
  - Be careful with the strap when you carry the camera. It could easily catch on stray objects and cause serious damage.
- Do not touch the metallic parts of the camera for a long period of time at low temperatures.
  - This may damage your skin. At low temperatures, handle the camera while wearing gloves.

## Battery Handling Precautions

Follow these important guidelines to prevent batteries from leaking, overheating, burning, exploding, or causing electrical shocks or burns.

### DANGER

- The camera uses a lithium ion battery specified by Olympus. Charge the battery with the specified charger. Do not use any other chargers.
- Never heat or incinerate batteries.
- Take precautions when carrying or storing batteries to prevent them from coming into contact with any metal objects such as jewelry, pins, fasteners, etc.
- Never store batteries where they will be exposed to direct sunlight, or subjected to high temperatures in a hot vehicle, near a heat source, etc.
- To prevent causing battery leaks or damaging their terminals, carefully follow all instructions regarding the use of batteries. Never attempt to disassemble a battery or modify it in any way, solder, etc.
- If battery fluid gets into your eyes, flush your eyes immediately with clear, cold running water and seek medical attention immediately.
- Always store batteries out of the reach of small children. If a child accidentally swallows a battery, seek medical attention immediately.

### WARNING

- Keep batteries dry at all times.
- To prevent batteries from leaking, overheating, or causing a fire or explosion, use only batteries recommended for use with this product.
- Insert the battery carefully as described in the operating instructions.
- If rechargeable batteries have not been recharged within the specified time, stop charging them and do not use them.
- Do not use a battery if it is cracked or broken.
- If a battery leaks, becomes discolored or deformed, or becomes abnormal in any other way during operation, stop using the camera.
- If a battery leaks fluid onto your clothing or skin, remove the clothing and flush the affected area with clean, running cold water immediately. If the fluid burns your skin, seek medical attention immediately.
- Never subject batteries to strong shocks or continuous vibration.

### CAUTION

- Before loading, always inspect the battery carefully for leaks, discoloration, warping, or any other abnormality.
- The battery may become hot during prolonged use. To avoid minor burns, do not remove it immediately after using the camera.
- Always unload the battery from the camera before storing the camera for a long period.

## Caution for Usage Environment

- To protect the high-precision technology contained in this product, never leave the camera in the places listed below, no matter if in use or storage:
  - Places where temperatures and/or humidity are high or go through extreme changes. Direct sunlight, beaches, locked cars, or near other heat sources (stove, radiator, etc.) or humidifiers.
  - In sandy or dusty environments.
  - Near flammable items or explosives.
  - In wet places, such as bathrooms or in the rain. When using products with weatherproof designs, read their manuals as well.
  - In places prone to strong vibrations.
- Never drop the camera or subject it to severe shocks or vibrations.
- When mounted on a tripod, adjust the position of the camera with the tripod head. Do not twist the camera.
- Do not touch electric contacts on cameras.
- Do not leave the camera pointed directly at the sun. This may cause lens or shutter curtain damage, color failure, ghosting on the CCD, or may possibly cause fires.
- Do not push or pull severely on the lens.
- Before storing the camera for a long period, remove the batteries. Select a cool, dry location for storage to prevent condensation or mold from forming inside the camera. After storage, test the camera by turning it on and pressing the shutter button to make sure that it is operating normally.
- Always observe the operating environment restrictions described in the camera's manual.

## Battery Handling Precautions

- This camera uses a lithium ion battery specified by Olympus. Do not use any other type of battery.
- If the battery's terminals get wet or greasy, camera contact failure may result. Wipe the battery well with a dry cloth before use.
- Always charge a battery when using it for the first time, or if it has not been used for a long period.
- When operating the camera with battery power at low temperatures, try to keep the camera and spare battery as warm as possible. A battery that has run down at low temperatures may be restored after it is warmed at room temperature.
- The number of pictures you can take may vary depending on the shooting conditions or battery.
- Before going on a long trip, and especially before traveling abroad, purchase extra batteries. A recommended battery may be difficult to obtain while traveling.
- Please recycle batteries to help save our planet's resources. When you throw away dead batteries, be sure to cover their terminals and always observe local laws and regulations.

## LCD Monitor

- Do not push the monitor forcibly; otherwise the image may become vague, resulting in a playback mode failure or damage to the monitor.
- A strip of light may appear on the top/bottom of the monitor, but this is not a malfunction.
- When a subject is viewed diagonally in the camera, the edges may appear zigzagged on the monitor. This is not a malfunction; it will be less noticeable in playback mode.
- In places subject to low temperatures, the LCD monitor may take a long time to turn on or its color may change temporarily. When using the camera in extremely cold places, it is a good idea to occasionally place it in a warm place. An LCD monitor exhibiting poor performance due to low temperatures will recover in normal temperatures.
- The LCD used for the monitor is made with high-precision technology. However, black spots or bright spots of light may appear constantly on the LCD monitor. Due to its characteristics or the angle at which you are viewing the monitor, the spot may not be uniform in color and brightness. This is not a malfunction.

## Legal and Other Notices

- Olympus makes no representations or warranties regarding any damages, or benefit expected by using this unit lawfully, or any request from a third person, which are caused by the inappropriate use of this product.
- Olympus makes no representations or warranties regarding any damages or any benefit expected by using this unit lawfully which are caused by erasing picture data.

## Disclaimer of Warranty

- Olympus makes no representations or warranties, either expressed or implied, by or concerning any content of these written materials or software, and in no event shall be liable for any implied warranty of merchantability or fitness for any particular purpose or for any consequential, incidental or indirect damages (including but not limited to damages for loss of business profits, business interruption and loss of business information) arising from the use or inability to use these written materials or software or equipment. Some countries do not allow the exclusion or limitation of liability for consequential or incidental damages, so the above limitations may not apply to you.
- Olympus reserves all rights to this manual.

## Warning

Unauthorized photographing or use of copyrighted material may violate applicable copyright laws. Olympus assumes no responsibility for unauthorized photographing, use or other acts that infringe upon the rights of copyright owners.

## Copyright Notice

All rights reserved. No part of these written materials or this software may be reproduced or used in any form or by any means, electronic or mechanical, including photocopying and recording or the use of any type of information storage and retrieval system, without the prior written permission of Olympus. No liability is assumed with respect to the use of the information contained in these written materials or software, or for damages resulting from the use of the information contained therein. Olympus reserves the right to alter the features and contents of this publication or software without obligation or advance notice.

## FCC Notice

- Radio and Television Interference
- Changes or modifications not expressly approved by the manufacturer may void the user's authority to operate this equipment. This equipment has been tested and found to comply with the limits for a Class B digital device, pursuant to Part 15 of the FCC Rules. These limits are designed to provide reasonable protection against harmful interference in a residential installation.
- This equipment generates, uses, and can radiate radio frequency energy and, if not installed and used in accordance with the instructions, may cause harmful interference to radio communications.
- However, there is no guarantee that interference will not occur in a particular installation. If this equipment does cause harmful interference to radio or television reception, which can be determined by turning the equipment off and on, the user is encouraged to try to correct the interference by one or more of the following measures:
  - Adjust or relocate the receiving antenna.
  - Increase the distance between the camera and receiver.
  - Connect the equipment to an outlet on a circuit different from that to which the receiver is connected.
  - Consult your dealer or an experienced radio/TV technician for help. Only the OLYMPUS-supplied USB cable should be used to connect the camera to USB enabled personal computers (PC).

Any unauthorized changes or modifications to this equipment would void the user's authority to operate it.



## Representative plug of power supply cord of countries/regions around the world



A Type  
(American Type)



B Type  
(British Type)



BF Type  
(British Type)



B3 Type  
(British Type)



C Type  
(CEE Type)



SE Type  
(CEE Type)



O Type  
(Oceania Type)

The representative supply voltage and plug type are described in this chart.  
Depending on the area, different types of plugs and supply voltages are used.

Attention: Power cord meeting demands from each country shall be used.

- For only the United States

Use a UL Listed, 1.8 - 3 m (6 - 10 ft), Type SPT-2 or NISPT-2, AWG no. 18 power supply cord, rated for 125 V 7 A, with a non-polarized NEMA 1-15P plug rated for 125 V 15 A".

### Europe

Countries/Regions	Voltage	Frequency (Hz)	Plug type
Austria	230	50	C
Belgium	230	50	C
Czech	220	50	C
Denmark	230	50	C
Finland	230	50	C
France	230	50	C
Germany	230	50	C
Greece	220	50	C
Hungary	220	50	C
Iceland	230	50	C
Ireland	230	50	C/BF
Italy	220	50	C
Luxemburg	230	50	C
Netherlands	230	50	C
Norway	230	50	C
Poland	220	50	C
Portugal	230	50	C
Romania	220	50	C
Russia	220	50	C
Slovak	220	50	C
Spain	127/230	50	C
Sweden	230	50	C
Switzerland	230	50	C
UK	240	50	BF

### Asia

Countries/Regions	Voltage	Frequency (Hz)	Plug type
China	220	50	A
Hong Kong	200/220	50	BF
India	230/240	50	C
Indonesia	127/230	50	C
Japan	100	50/60	A
Korea (rep)	220	60	C
Malaysia	240	50	BF
Philippines	220/230	60	A/C
Singapore	230	50	BF
Taiwan	110	60	A
Thailand	220	50	C/BF
Vietnam	220	50	A/C

### Oceania

Countries/Regions	Voltage	Frequency (Hz)	Plug type
Australia	240	50	O
New Zealand	230/240	50	O

### North America

Countries/Regions	Voltage	Frequency (Hz)	Plug type
Canada	120	60	A
USA	120	60	A

### Central America

Countries/Regions	Voltage	Frequency (Hz)	Plug type
Bahamas	120/240	60	A
Costa Rica	110	60	A
Cuba	110/220	60	A/C
Dominican (rep)	110	60	A
El Salvador	110	60	A
Guatemala	120	60	A
Honduras	110	60	A
Jamaica	110	50	A
Mexico	120/127	60	A
Nicaragua	120/240	60	A
Panama	110/220	60	A

### South America

Countries/Regions	Voltage	Frequency (Hz)	Plug type
Argentina	220	50	C/BF/O
Brazil	127/220	60	A/C
Chile	220	50	C
Colombia	120	60	A
Peru	220	60	A/C
Venezuela	120	60	A

### Middle East

Countries/Regions	Voltage	Frequency (Hz)	Plug type
Iran	220	50	C/BF
Iraq	220	50	C/BF
Israel	230	50	C
Saudi Arabia	127/220	50	A/C/BF
Turkey	220	50	C
UAE	240	50	C/BF

### Africa

Countries/Regions	Voltage	Frequency (Hz)	Plug type
Algeria	127/220	50	C
Congo (dem)	220	50	C
Egypt	220	50	C
Ethiopia	220	50	C
Kenya	240	50	C/BF
Nigeria	230	50	C/BF
South Africa	220/230	50	C/BF
Tanzania	230	50	C/BF
Tunisia	220	50	C

## For customers in North and South America

### For customers in USA

Declaration of Conformity

Model Number : Stylus 1050 SW/  
µ 1050 SW

Trade Name : OLYMPUS

Responsible Party :  
OLYMPUS IMAGING AMERICA INC.

Address : 3500 Corporate  
Parkway, P.O. Box  
610, Center Valley, PA  
18034-0610, U.S.A.

Telephone Number : 484-896-5000

Tested To Comply With FCC Standards  
FOR HOME OR OFFICE USE

This device complies with Part 15 of the FCC rules. Operation is subject to the following two conditions:

- (1) This device may not cause harmful interference.
- (2) This device must accept any interference received, including interference that may cause undesired operation.

### For customers in Canada

This Class B digital apparatus meets all requirements of the Canadian Interference-Causing Equipment Regulations.

### Use Only Dedicated Rechargeable Battery and Battery Charger

We strongly recommend that you use only the genuine Olympus dedicated rechargeable battery and battery charger with this camera. Using a non-genuine rechargeable battery and/or battery charger may result in fire or personal injury due to leakage, heating, ignition or damage to the battery. Olympus does not assume any liability for accidents or damage that may result from the use of a battery and/or battery charger that are not genuine Olympus accessories.

## OLYMPUS WORLDWIDE LIMITED WARRANTY - IMAGING PRODUCTS

Olympus warrants that the enclosed Olympus® imaging product(s) and related Olympus® accessories (individually a "Product" and collectively the "Products") will be free from defects in materials and workmanship under normal use and service for a period of one (1) year from the date of purchase.

If any Product proves to be defective within the one-year warranty period, the customer must return the defective Product to any of Olympus Service Centers, following the procedure set forth below (See "WHAT TO DO WHEN SERVICE IS NEEDED").

Olympus, at its sole discretion, will repair, replace, or adjust the defective Product, provided that Olympus investigation and factory inspection disclose that (a) such defect developed under normal and proper use and (b) the Product is covered under this limited warranty.

Repair, replacement, or adjustment of defective Products shall be Olympus's sole obligation and the customer's sole remedy hereunder.

The customer is liable and shall pay for shipment of the Products to the Olympus Service Center. Olympus shall not be obligated to perform preventive maintenance, installation, deinstallation, or maintenance.

Olympus reserves the right to (i) use reconditioned, refurbished, and/or serviceable used parts (that meet Olympus's quality assurance standards) for warranty or any other repairs and (ii) make any internal or external design and/or feature changes on or to its products without any liability to incorporate such changes on or to the Products.

## **WHAT IS NOT COVERED BY THIS LIMITED WARRANTY**

Excluded from this limited warranty and not warranted by Olympus in any fashion, either express, implied, or by statute, are:

- (a) products and accessories not manufactured by Olympus and/or not bearing the "OLYMPUS" brand label (the warranty coverage for products and accessories of other manufacturers, which may be distributed by Olympus, is the responsibility of the manufacturers of such products and accessories in accordance with the terms and duration of such manufacturers' warranties);
- (b) any Product which has been disassembled, repaired, tampered with, altered, changed, or modified by persons other than Olympus's own authorized service personnel unless repair by others is made with the written consent of Olympus;
- (c) defects or damage to the Products resulting from wear, tear, misuse, abuse, negligence, sand, liquids, impact, improper storage, nonperformance of scheduled operator and maintenance items, battery leakage, use of non-"OLYMPUS" brand accessories, consumables, or supplies, or use of the Products in combination with non-compatible devices;
- (d) software programs;
- (e) supplies and consumables (including but not limited to lamps, ink, paper, film, prints, negatives, cables and batteries); and/or
- (f) Products which do not contain a validly placed and recorded Olympus serial number, unless they are a model on which Olympus does not place and record serial numbers.

EXCEPT FOR THE LIMITED WARRANTY SET FORTH ABOVE, OLYMPUS MAKES NO AND DISCLAIMS ALL OTHER REPRESENTATIONS, GUARANTIES, CONDITIONS, AND WARRANTIES CONCERNING THE PRODUCTS, WHETHER DIRECT OR INDIRECT, EXPRESS OR IMPLIED, OR ARISING UNDER ANY STATUTE, ORDINANCE, COMMERCIAL USAGE OR OTHERWISE, INCLUDING BUT NOT LIMITED TO ANY WARRANTY OR REPRESENTATION AS TO THE SUITABILITY, DURABILITY, DESIGN, OPERATION, OR CONDITION OF THE PRODUCTS (OR ANY PART THEREOF) OR THE MERCHANTABILITY OF THE PRODUCTS OR THEIR FITNESS FOR A PARTICULAR PURPOSE, OR RELATING TO THE INFRINGEMENT OF ANY PATENT, COPYRIGHT, OR OTHER PROPRIETARY RIGHT USED OR INCLUDED THEREIN.

IF ANY IMPLIED WARRANTIES APPLY AS A MATTER OF LAW, THEY ARE LIMITED IN DURATION TO THE LENGTH OF THIS LIMITED WARRANTY.

SOME STATES MAY NOT RECOGNIZE A DISCLAIMER OR LIMITATION OF WARRANTIES AND/OR LIMITATION OF LIABILITY SO THE ABOVE DISCLAIMERS AND EXCLUSIONS MAY NOT APPLY.

THE CUSTOMER MAY ALSO HAVE DIFFERENT AND/OR ADDITIONAL RIGHTS AND REMEDIES THAT VARY FROM STATE TO STATE.

THE CUSTOMER ACKNOWLEDGES AND AGREES THAT OLYMPUS SHALL NOT BE RESPONSIBLE FOR ANY DAMAGES THAT THE CUSTOMER MAY INCUR FROM DELAYED SHIPMENT, PRODUCT FAILURE, PRODUCT DESIGN, SELECTION, OR PRODUCTION, IMAGE OR DATA LOSS OR IMPAIRMENT OR FROM ANY OTHER CAUSE, WHETHER LIABILITY IS ASSERTED IN CONTRACT, TORT (INCLUDING NEGLIGENCE AND STRICT PRODUCT LIABILITY) OR OTHERWISE. IN NO EVENT SHALL OLYMPUS BE LIABLE FOR ANY INDIRECT, INCIDENTAL, CONSEQUENTIAL OR SPECIAL DAMAGES OF ANY KIND (INCLUDING WITHOUT LIMITATION LOSS OF PROFITS OR LOSS OF USE), WHETHER OR NOT OLYMPUS SHALL BE OR SHOULD BE AWARE OF THE POSSIBILITY OF SUCH POTENTIAL LOSS OR DAMAGE.

Representations and warranties made by any person, including but not limited to dealers, representatives, salespersons, or agents of Olympus, which are inconsistent or in conflict with or in addition to the terms of this limited warranty, shall not be binding upon Olympus unless reduced to writing and approved by an expressly authorized officer of Olympus. This limited warranty is the complete and exclusive statement of warranty which Olympus agrees to provide with respect to the Products and it shall supersede all prior and contemporaneous oral or written agreements, understandings, proposals, and communications pertaining to the subject matter hereof. This limited warranty is exclusively for the benefit of the original customer and cannot be transferred or assigned.

## WHAT TO DO WHEN SERVICE IS NEEDED

The customer must transfer any image or other data saved on a Product to another image or data storage medium and/or remove any film from the Product prior to sending the Product to Olympus for service.

IN NO EVENT SHALL OLYMPUS BE RESPONSIBLE FOR SAVING, KEEPING OR MAINTAINING ANY IMAGE OR DATA SAVED ON A PRODUCT RECEIVED BY IT FOR SERVICE, OR ON ANY FILM CONTAINED WITHIN A PRODUCT RECEIVED BY IT FOR SERVICE, NOR SHALL OLYMPUS BE RESPONSIBLE FOR ANY DAMAGES IN THE EVENT ANY IMAGE OR DATA IS LOST OR IMPAIRED WHILE SERVICE IS BEING PERFORMED (INCLUDING, WITHOUT LIMITATION, DIRECT, INDIRECT, INCIDENTAL, CONSEQUENTIAL OR SPECIAL DAMAGES, LOSS OF PROFITS OR LOSS OF USE), WHETHER OR NOT OLYMPUS SHALL BE OR SHOULD BE AWARE OF THE POSSIBILITY OF SUCH POTENTIAL LOSS OR IMPAIRMENT.

Package the Product carefully using ample padding material to prevent damage in transit and either deliver it to the Authorized Olympus Dealer that sold you the Product or ship it postage prepaid and insured to any of our Olympus Service Centers.

When returning Products for service, your package should include the following:

- 1 Sales receipt showing date and place of purchase.
- 2 Copy of this limited warranty **bearing the Product serial number corresponding to the serial number on the Product** (unless it is a model on which Olympus does not place and record serial numbers).
- 3 A detailed description of the problem.
- 4 Sample prints, negatives, digital prints (or files on disk) if available and related to the problem.

When service is completed, the Product will be returned to you postage prepaid.

## WHERE TO SEND PRODUCT FOR SERVICE

See "WORLDWIDE WARRANTY" for the nearest service center.

## INTERNATIONAL WARRANTY SERVICE

International warranty service is available under this warranty.

## Trademarks

- IBM is a registered trademark of International Business Machines Corporation.
- Microsoft and Windows are registered trademarks of Microsoft Corporation.
- Macintosh is a trademark of Apple Inc.
- xD-Picture Card™ is a trademark.
- microSD is a trademark of the SD Association.
- All other company and product names are registered trademarks and/or trademarks of their respective owners.
- The standards for camera file systems referred to in this manual are the "Design rule for Camera File system/DCF" standards stipulated by the Japan Electronics and Information Technology Industries Association (JEITA).

## SPECIFICATIONS

### Camera

<b>Product type</b>	: Digital camera (for shooting and displaying)
<b>Recording system</b>	
<b>Still pictures</b>	: Digital recording, JPEG (in accordance with Design rule for Camera File system (DCF))
<b>Applicable standards</b>	: Exif 2.2, Digital Print Order Format (DPOF), PRINT Image Matching III, PictBridge
<b>Sound with still pictures</b>	: Wave format
<b>Movie</b>	: AVI Motion JPEG
<b>Memory</b>	: Internal memory xD-Picture Card (16 MB to 2 GB) (TypeH/M/M+, Standard) microSD card/microSDHC card (with the supplied microSD Attachment)
<b>No. of effective pixels</b>	: 10,100,000 pixels
<b>Image pickup device</b>	: 1/2.33" CCD (primary color filter), 10,700,000 pixels (gross)
<b>Lens</b>	: Olympus lens 6.7 to 20.1 mm, f3.5 to 5.0 (equivalent to 38 to 114 mm on a 35mm camera)
<b>Photometric system</b>	: Digital ESP metering, spot metering system
<b>Shutter speed</b>	: 4 to 1/1000 sec.
<b>Shooting range</b>	: 0.5 m (1.6 ft.) to ∞(W/T) (normal) 0.2 m (0.7 ft.) to ∞(W), 0.3 m (1.0 ft.) to ∞(T) (macro mode) 0.07 m (2.8 in.) to 0.5 m (1.6 ft.) (W only) (super macro mode) 0.07 m (2.8 in.) to 0.2 m (0.7 ft.) (W only) (S-macro LED mode)
<b>Monitor</b>	: 2.7" TFT color LCD display, 230,000 dots
<b>Flash charge time</b>	: Approx. 3.5 sec. (for full flash discharge at room temperature using a new fully charged battery)
<b>Connector</b>	: Multi-connector (DC-IN jack USB connector, A/V OUT jack)
<b>Automatic calendar system</b>	: 2000 up to 2099
<b>Water resistance</b>	
<b>Type</b>	: Equivalent to IEC Standard publication 529 IPX8 (under OLYMPUS test conditions), available in 3 m (9.8 feet) deep water
<b>Meaning</b>	: Camera can normally be used under water at a specified water pressure.
<b>Dust resistance</b>	: IEC Standard publication 529 IP6X (under OLYMPUS test conditions)
<b>Operating environment</b>	
<b>Temperature</b>	: -10 °C to 40 °C (14 °F to 104 °F) (operation)/ -20 °C to 60 °C (-4 °F to 140 °F) (storage)
<b>Humidity</b>	: 30 % to 90 % (operation)/10 % to 90 % (storage)
<b>Power supply</b>	: One Olympus lithium ion battery (LI-42B/LI-40B) or Olympus AC adapter
<b>Dimensions</b>	: 93.0 mm (W) × 62.0 mm (H) × 22.6 mm (D) (3.7 × 2.4 × 0.9 in.) (excluding protrusions)
<b>Weight</b>	: 152 g (5.4 oz) (excluding battery and card)

## Lithium ion battery (LI-42B)

<b>Product type</b>	: Lithium ion rechargeable battery
<b>Standard voltage</b>	: DC 3.7 V
<b>Standard capacity</b>	: 740 mAh
<b>Battery life</b>	: Approx. 300 full charges (varies on usage)
<b>Operating environment</b>	
<b>Temperature</b>	: 0°C to 40°C (32°F to 104°F) (charging)/ -10°C to 60°C (14°F to 140°F) (operation)/ -20°C to 35°C (14°F to 95°F) (storage)
<b>Dimensions</b>	: 31.5 × 39.5 × 6.0 mm (1.2 × 1.5 × 0.2 in.)
<b>Weight</b>	: Approx. 15 g (0.5 oz)

## Battery charger (LI-40C)

<b>Power requirements</b>	: AC 100 to 240 V (50 to 60 Hz) 3.2 VA (100V) to 5.0 VA (240V)
<b>Output</b>	: DC 4.2 V, 200 mA
<b>Charging time</b>	: Approx. 5 hours
<b>Operating environment</b>	
<b>Temperature</b>	: 0°C to 40°C (32°F to 104°F) (operation)/ -20°C to 60°C (-4°F to 140°F) (storage)
<b>Dimensions</b>	: 62.0 × 23.0 × 90.0 mm (2.4 × 0.9 × 3.5 in.)
<b>Weight</b>	: Approx. 65 g (2.2 oz)

## Using in low temperatures

Low temperature operation of the optional Olympus xD-Picture Card and lithium ion battery are guaranteed to 0°C (32°F). However, the following have been tested for use with this product in temperatures up to -10°C (14°F).

### Olympus xD-Picture Card

	16MB	32MB	64MB	128MB	256MB	512MB	1GB	2GB
Standard	✓	✓	✓	✓	✓	✓		
TypeM/M+					✓	✓	✓	✓
TypeH					✓	✓	✓	✓

✓ Operation confirmed

### Olympus lithium ion battery

LI-42B  
LI-40B

- The number of storable still pictures is reduced in low temperatures.

## microSD attachment

<b>Product type</b>	: Attachment for microSD
<b>Operating Environment</b>	
<b>Temperature</b>	: -10 to 40°C (14 to 104°F) (operation) / -20 to 65°C (-4 to 149°F) (storage)
<b>Humidity</b>	: 95% and below (operation) / 85% and below (storage)
<b>Dimensions</b>	: 25.0 mm (W) x 20.3 mm (H) x 1.7 mm (D) (1.0 x 0.8 x 0.07 in.) (Handle: 2.2 mm (0.09 in.))
<b>Weight</b>	: Approx. 0.9 g (0.03 oz)

Design and specifications subject to change without notice.



## A

AC adapter.....	64
ADD FAVORITE ★.....	36
AF lock.....	18
AF MODE.....	31
ALARM CLOCK.....	46
ALL (PERFECT FIX).....	36
ALL (SLIDESHOW).....	36
ALL INDEX.....	51
ALL PRINT.....	51
All-image print reservation  .....	54
AUTO (FILE NAME).....	44
AUTO (ISO).....	29
AUTO (WB) WB AUTO.....	29
AV cable.....	10, 47

## B

BACKUP.....	41
Battery.....	10, 11, 58, 62, 63
Battery charger.....	10, 63
BEEP.....	43
BGM.....	36
Black & White.....	37



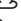

## C

CALENDAR.....	38
CALENDAR (SLIDESHOW).....	36
CALIBRATE.....	48
Calendar view.....	25
CAMERA MENU  .....	29
Card.....	11, 12, 64
Closeup view  .....	25
Cloudy day  .....	29
COLOR 1/2/3.....	42
COLOR EDIT.....	37
COMBINE IN CAMERA1.....	33
COMBINE IN CAMERA2.....	33
COMBINE IN PC.....	33
COMPRESSION.....	28



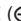

## Connection

To Computer.....	56
To Printer.....	50
To Television.....	47
Cropping a picture  .....	37, 52
CUSTOM PRINT.....	51

## D

DATE  .....	54
DATE (PRINT INFO).....	52
Date and time  .....	13, 45
Digital image stabilization mode  .....	19
DIGITAL ZOOM.....	30
Direct printing.....	50
Display language  .....	13, 41
DIS MOVIE MODE.....	30
DPOF.....	53
DRIVE.....	29
DUALTIME  .....	45





## E

EASY PRINT.....	50
EDIT  .....	37, 38
Erase	
ALL ERASE.....	39
ERASE  .....	39
Erase.....	39
SEL.IMAGE.....	39
Single image erase.....	17
ESP.....	30
ESP/  .....	30
Exposure.....	15
Exposure compensation  .....	21

## F

FACE DETECT.....	31
FADER (SLIDESHOW).....	36
FILE NAME.....	44
File name.....	44



FILE NAME (PRINT INFO) .....	52
FILL IN  .....	21
FINE .....	28
FINE ZOOM .....	30
FLASH AUTO .....	21
Flash charge .....	58
Flash mode  .....	21
FLASH OFF  .....	21
Fluorescent lamp 1/2/3  .....	29
FORMAT .....	41
Format .....	41
FRAME RATE .....	28
FUNC menu .....	24



## G

<b>GUIDE</b> (Shooting guide) .....	24
-------------------------------------	----

## H

High speed sequential shooting  .....	29
Histogram display .....	23, 25



## I

IESP .....	31
IMAGE QUALITY  .....	28
IMAGE SIZE .....	28
INDEX .....	38
Index view  .....	25
Information displays .....	23, 25
Internal memory .....	11, 64
ISO .....	29

## L



LED ILLUMINATOR .....	23, 47
LIGHTING FIX .....	36
Lithium ion battery .....	10

## M

MACRO  .....	22
Macro mode  .....	22
MEMORY FORMAT .....	41
Menu .....	3
MENU COLOR .....	42
Menu guide .....	3

microSD Attachment .....	10, 12, 66
microSD card .....	12, 66
microSDHC card .....	12, 66
Monitor brightness adjustment  .....	45
MOVIE (SLIDESHOW) .....	36
MULTI PRINT .....	51









## N

NO (  ) .....	54
NORMAL .....	28
NORMAL (MENU COLOR) .....	42
NORMAL (SLIDESHOW) .....	36
NTSC .....	46
Number of prints (  x) .....	52

## O

OLYMPUS Master .....	10, 56
Optical zoom .....	20

## P

















PAL .....	46
PANORAMA  .....	33
Panorama playback .....	26
PC .....	56
PERFECT FIX  .....	36
PictBridge .....	50
Picture rotation  .....	39
PIXEL MAPPING .....	44
Play "My Favorite"  .....	26
PLAYBACK MENU  .....	38, 39
Playback mode  .....	16
Playback on a TV .....	47
POWER SAVE .....	47
PRINT ORDER  .....	40, 51
Print reservations .....	53
Printing pictures .....	50
Protect  .....	38
PW ON SETUP .....	42

## R

REC VIEW .....	43
REDEYE  .....	21
REDEYE FIX .....	36
RESET  .....	35

RESET (FILE NAME) .....	44
Resizing  .....	37

## S

Saturation (High).....	37
Saturation (Low) .....	37
<b>SCN</b> (Scene)  .....	18, 31
SCREEN .....	42
SELFTIMER  .....	22
Sepia.....	37
Sequential shooting  .....	29
SETUP  .....	41
SHADOW ADJ .....	20
Shooting mode.....	15
Shooting movies  .....	19
Shooting still pictures (Full auto mode) <b>AUTO</b> .....	15
Shooting still pictures  .....	18
SHUTTER SOUND .....	43
SILENT MODE  .....	49
Single-image print reservation  .....	53
Single-frame shooting  .....	29
SLIDE (SLIDESHOW) .....	36
SLIDESHOW  .....	36
S-MACRO LED  .....	22
Sound recording Adding sound to still pictures  .....	39
Recording sound with still pictures  .....	31
SOUND SETTINGS .....	43
SPOT (AF MODE) .....	31
Spot metering  .....	30
STILL PICTURE (SLIDESHOW) .....	36
Strap .....	10
Sunny day  .....	29
SUPER MACRO  .....	22

## T

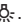
TAP CONTROL .....	48
TIME (  ) .....	54
Top menu .....	5
Tungsten light  .....	29
Turn the camera on .....	13, 15
TYPE .....	36

## U

USB cable.....	10, 50, 56
----------------	------------

## V

VIDEO OUT .....	46
VOLUME.....	42
VOLUME  .....	43

## W

Warning sound  .....	43
White balance WB .....	29

## X

xD-Picture Card .....	11, 64
-----------------------	--------

## Z

Zoom.....	20
ZOOM (SLIDESHOW) .....	36







# OLYMPUS®

<http://www.olympusamerica.com/>

## OLYMPUS IMAGING AMERICA INC.

3500 Corporate Parkway, P.O. Box 610, Center Valley, PA 18034-0610, U.S.A. Tel. 484-896-5000

### Technical Support (USA)

24/7 online automated help: <http://www.olympusamerica.com/support>

Phone customer support: Tel. 1-888-553-4448 (Toll-free)

Our phone customer support is available from 8 am to 10 pm (Monday to Friday) ET

<http://olympusamerica.com/contactus>

Olympus software updates can be obtained at: <http://www.olympusamerica.com/digital>

To find the nearest Service Centers, please visit: <http://www.olympusamerica.com/digital>, and click on the Worldwide Warranty icon at the bottom of the page.

### Service Centers

#### U.S.A.:

**California** Olympus Imaging America Inc.  
10805 Holder Street Suite 170  
Cypress, CA 90630-5145  
Tel: (888) 553-4448

**New York** Olympus Imaging America Inc.  
400 Rabro Drive  
Hauppauge, NY 11788-4258  
Tel: (888) 553-4448

#### Canada:

**Olympus Canada Inc.**  
**Consumer Products Group**  
151 Telson Road  
Markham, Ontario Canada L3R 1E7  
Tel. (888)553-4448

#### Mexico:

**Olympus Imaging de Mexico S.A. de C.V.**  
WTC Mexico,  
Montecito No.38 - Lobby - Office 3  
Col. Napoles, Mexico D.F. 03810  
Tel. (01800)800-2128  
E-mail: [oimx@olympus.com](mailto:oimx@olympus.com)

#### Argentina:

**Jesus Labrador**  
Paraguay 755 PB, C1057AAI - Buenos Aires  
Tel: (011) 4313-3174 Fax: (011) 4312-5239  
E-Mail: [olympus@jesuslabrador.com.ar](mailto:olympus@jesuslabrador.com.ar)

**Jesus Labrador**  
Bartolome Mitre 860  
C1036AAP - Buenos Aires  
Tel: (011) 4331-1227 Fax: (011) 4331-1247  
E-mail: [service@basr.com.ar](mailto:service@basr.com.ar)

#### Brazil:

**Olympus Optical do Brasil Ltda.**  
Rua do Rocio 430 - 2 andar - Vila Olimpia  
CEP 04552-906 - São Paulo - Brasil  
Tel: +55 11 3046-6427  
Fax: +55 11 3046-6412  
E-mail: [obl-cameras@olympus.com](mailto:obl-cameras@olympus.com)

#### Chile:

**REIFSCHNEIDER S.A.**  
Camino El Conquistador del Monte 5024  
Huechuraba, Santiago  
Tel: 56-2-6781200 Fax: 56-2-6781202  
E-mail : [olympus@reifschneider.cl](mailto:olympus@reifschneider.cl),  
[serviciotecnico@reifschneider.cl](mailto:serviciotecnico@reifschneider.cl)

#### Colombia:

**CV Tronica LTDA**  
Calle 68 No 12-57, Bogota  
Tel: (0571)235-7260/348-1573  
Fax: (0571) 348-1574  
E-mail: [servicio@cvtronica.com](mailto:servicio@cvtronica.com)

**CV Tronica LTDA**  
Cra 9 No 23-49 Local 215 C.C Intercentro, Bogota  
Tel: (0571)284-4365

**CV Tronica LTDA**  
Av. Cra 15 No 105A-22 Piso 2 Local 5, Bogota  
Tel: (0571)637-3540

#### Panama:

**FOTOSER**  
Edif. El Paical, Oficina No3, P.A.  
Urb. Herbruger, Transistmica  
(Detras del S/M Riba Smith),  
Tel/Fax: (507) 261-0436  
E-mail: [rearanda@rocketmail.com](mailto:rearanda@rocketmail.com)

#### Peru:

**Electrónica Lau Si**  
Av. Oscar R. Benavides 4707 Callao  
(Ex-Av. Condonal) Lima, Peru  
Tel:452-1333 Fax:451-6403  
Nextel:9816-5578  
E-mail: [Olympus@elausi.com.pe](mailto:Olympus@elausi.com.pe)

#### Uruguay:

**Fotocamara S.R.L.**  
Rondeau 1470 Montevideo  
Tel: (02) 900-2004 Fax: (02) 900-8430  
E-mail: [FOTOCAM@ADINET.COM.UY](mailto:FOTOCAM@ADINET.COM.UY)

#### Venezuela:

**Micron C.A.**  
4ta. transversal Urb. Horizonte,  
Edificio América, Mezanine, Caracas 1070-A  
Tel: (0212) 238-3526 Fax: (0212) 239-8598  
E-mail: [serviciotecnico@micron.com.ve](mailto:serviciotecnico@micron.com.ve)